

PART F

PRELIMINARY ENVIRONMENTAL OVERVIEW

UST/HAZARDOUS MATERIALS

Fuller Mossbarger Scott & May

May 2005

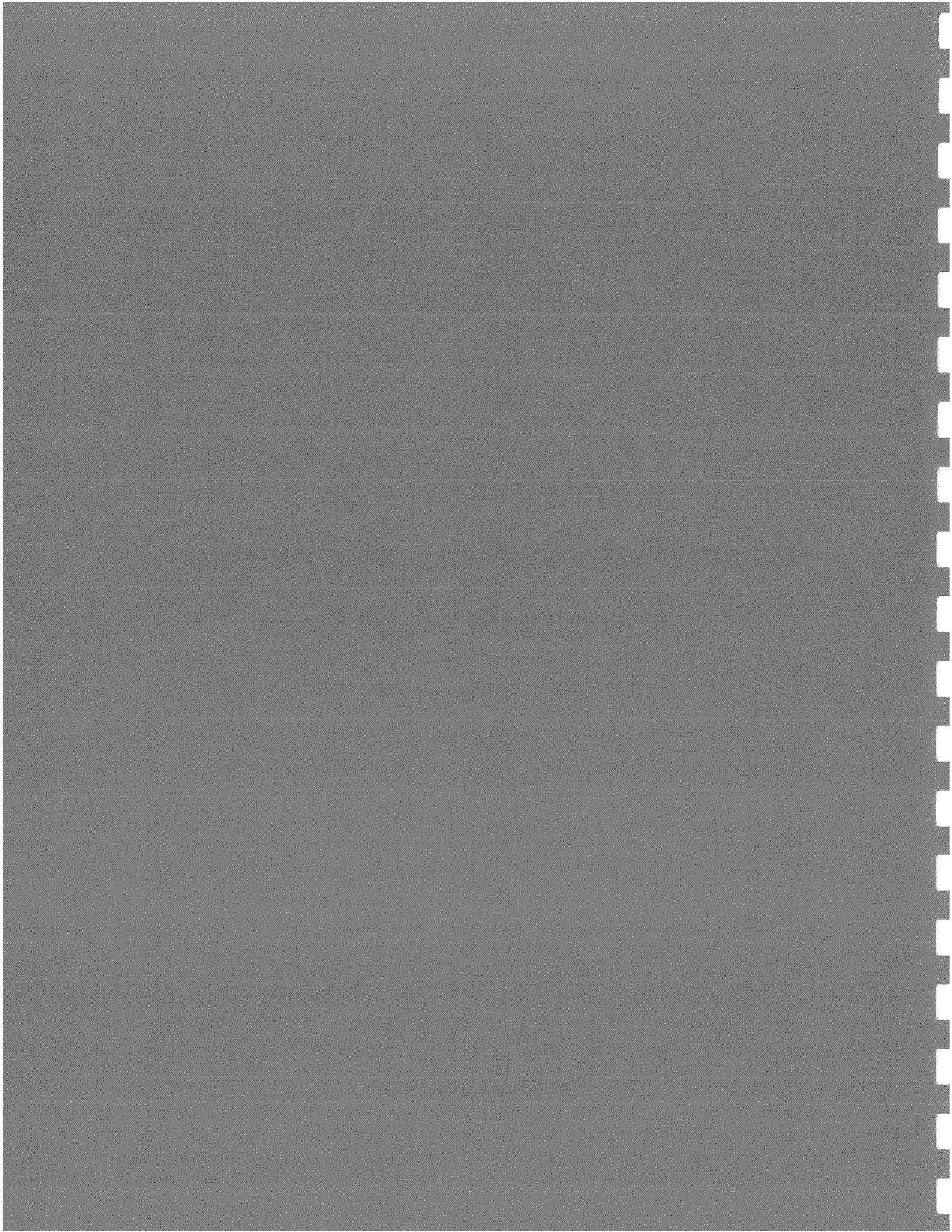

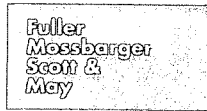

**Preliminary
Environmental Overview
UST/Hazardous Materials**

**Southside Drive Widening
Louisville, Kentucky**

Prepared for:
**Redwing Ecological Services, Inc.
Louisville, Kentucky**

May 2005



1901 Nelson Miller Parkway
Louisville, Kentucky
40223-2177
502-212-5000
502-212-5055 FAX
www.fmsmengineers.com

May 6, 2005

O.1.1.LV2004041L02

Ms. Kiersten Fuchs
Redwing Ecological Services, Inc.
129 South Sixth Street
Louisville, Kentucky 40202

Re: Preliminary Environmental Overview
UST/Hazardous Materials
Southside Drive Widening Project
Louisville, Kentucky

Dear Kiersten:

Fuller, Mossbarger, Scott and May Engineers, Inc. (FMSM) has completed a preliminary overview of hazardous materials/underground storage tank sites associated with the Southside Drive widening project. Attached is our report describing the environmental data obtained, along with site figures, photographs and agency documentation.

FMSM appreciates the opportunity to provide engineering services for the Southside Drive widening project. If you have questions regarding this report, please feel free to call our office.

Respectfully submitted,

FULLER, MOSSBARGER, SCOTT AND MAY
ENGINEERS, INC.

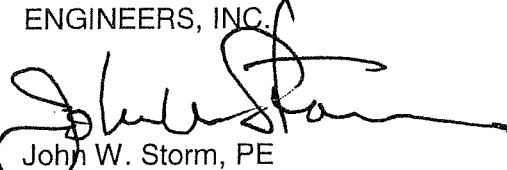

John W. Storm, PE
Project Manager

/cdm

Enclosures

Preliminary Environmental Overview UST/Hazardous Materials Southside Drive Widening Project Jefferson County, Kentucky

1. Project Description

Fuller, Mossbarger, Scott and May Engineers, Inc. (FMSM) performed a preliminary review of hazardous materials/underground storage tank sites associated with the Southside Drive widening project. The preliminary environmental review is a non-invasive review of information to assess for the presence of chemical and petroleum related conditions that have the potential to cause significant adverse environmental impact to the project. The purpose of our services was to identify *recognized UST/Hazardous Material conditions* associated with the proposed alignment. According to general assessment guidelines, the term *recognized environmental condition* means the presence or likely presence of hazardous substances or petroleum products on a property under conditions that indicate an existing release, past release, or a material threat of a release of any hazardous substances or petroleum products into structures on the property or into the ground, groundwater, or surface water of the property. The term is not intended to include *de minimus* conditions.

The proposed roadway widening project is located along Southside Drive between New Cut Road and Strawberry Lane. A vicinity plan is shown in Appendix A. The project is approximately 1.2 miles long and includes intersections at National Turnpike and Palatka Road. The northern portion of the alignment is characterized by commercial properties and businesses, while the southern portion of the alignment is primarily residential and institutional with the exception of the Southside Drive and New Cut Road intersection.

2. Site Investigation

FMSM personnel conducted a visual reconnaissance of the alignment and frontage properties. The reconnaissance was conducted by a driving tour and site reconnaissance at specific sites of interest. A map of the alignment is shown in Appendix A. Based on our preliminary review, we estimate the number of receptors as follows: 49 single family residences, 10 multi-unit residential buildings, 32 businesses, and 5 churches.

A list of environmental sites of interest was identified based on the site reconnaissance as well as records review. A summary of the environmental sites of interest, including the owner databases listed, and description of conditions is provided in Appendix B.

- | | |
|-------------------------------|----------------------|
| • Speedway SuperAmerica | 6821 Southside Drive |
| • Southside Cleaners | 6920 Southside Drive |
| • Ken Towery Tire Center | 6919 Southside Drive |
| • Kenwood Service Center | 6903 Southside Drive |
| • Goodyear Kaiser Tire Center | 7000 Southside Drive |
| • Rite Aid Drug Store | 7118 Southside Drive |
| • Auburndale Auto Parts | 7114 Southside Drive |
| • South Louisville Body Shop | 7105 Southside Drive |
| • Payday Advance | 7101 Southside Drive |
| • Captain D's | 7131 Southside Drive |

- BP Oil 5469 New Cut Road
- Valvoline Instant Oil 7401 3rd Street Road

2.1. Environmental Records Review

This assessment included a review of federal, state and local records of environmentally sensitive incidents and activities in the area. Federal and state databases were accessed through EDR, a commercial database retrieval company. State agencies were contacted directly for information concerning environmental activities or conditions representing a significant impact to the property.

2.2. Federal Databases

In accordance with several environmental assessment guidelines, we reviewed the following Standard Federal Environmental database records:

- National Priorities List (NPL)
- Comprehensive Environmental Response Compensation and Liability Information System (CERCLIS)
- CERCLIS No Further Remedial Action Planned (NFRAP)
- Resource Conservation and Recovery Act (RCRA) Corrective Action Report (CORRACTS)
- RCRA Treatment, Storage and Disposal Facilities
- RCRA Generators
- Emergency Response Notification System (ERNS)

NPL is the EPA database of hazardous waste sites identified for priority remedial action under the Superfund program. The NPL database search was conducted for an area extending one mile beyond the property limits. No NPL sites within the search area were identified.

The CERCLIS list is a compilation of EPA sites investigated or being investigated for a release or threatened release of hazardous substances. The database was searched for CERCLIS sites within one-half mile of the property. No CERCLIS sites were identified within the search area.

The Resource Conservation and Recovery Act (RCRA) program is used to identify and track hazardous wastes from the point of generation to the point of disposal. Any facility engaged in the generation, treatment, storage or disposal of hazardous wastes should appear in the RCRIS database. This database is divided into two groups, which are: (1) "treatment, storage and disposal" (TSD) facilities, and (2) "generators". The database was searched to identify TSD facilities within a one-half mile radius, and generators within a one-quarter mile radius of the property. No TSD sites were identified within the search area. Small quantity generator sites identified in the records search included:

- Paxton's One Hour Dry Cleaner
- Kenwood Service Center
- BP Oil (on New Cut)
- Valvoline Instant Oil

ERNS is a federal database listing of oil and hazardous material spills. The database was searched for ERNS sites within the property boundaries. Auburndale Auto Parts was identified on the ERNS list.

The following additional environmental record sources were checked:

- CONSENT: Superfund (CERCLA) Consent Decrees
- ROD: Records of Decision
- DELISTED NPL: National Property List Deletions
- FINDS: Facility Index System/Facility Identification Initiative Program Summary Report
- HMIRS: Hazardous Materials Information Reporting System
- MLTS: Material Licensing Tracking System
- MINES: Mines Master Index File
- NPL LIENS: Federal Superfund Liens
- PADS: PCB Activity Database System
- DOD: Department of Defense Sites
- US BROWNFIELDS: A Listing of Brownfields Sites
- RAATS: RCRA Administration Action Tracking System
- TRIS: Toxic Chemical Release Inventory System
- TSCA: Toxic Substances Control Act
- FTTTS: FIFRA/TSCA Tracking System – FIFRA (Federal Insecticide, Fungicide, & Rodenticide Act) TSCA (Toxic Substances Control Act)

Review of the additional lists indicated that no sites were found on the lists within the selected search distances from the subject site.

2.3. State Databases

In accordance with environmental review guidelines we reviewed the following Standard State Environmental database records:

- State Hazardous Waste Sites (SHWS)
- State Solid Waste Landfill List (SWLF)
- Voluntary Remediation Program Site List (VCP)
- Registered Underground Storage Tanks (UST)

The State of Kentucky does not publish a list of leaking underground storage tanks.

Sites listed on the State UST database include the following properties.

- Speedway SuperAmerica
- Ken Towery Tire Center
- Kenwood Service Center
- Goodyear Kaiser Center
- Rite Aid Drug Store
- South Louisville Body Shop
- Payday Advance
- BP Oil
- SuperAmerica (at Strawberry Lane)
- Valvoline Instant Oil

2.4. State Environmental Agency Files

The Kentucky Department for Environmental Protection (KDEP) is responsible for developing and enforcing regulations designed to protect the state's air, land, and water. FMSM made written requests to the following State agencies and inquired whether the agency maintains a file for the subject property.

- KDEP Division of Waste Management, Ms. Maria Wood
- KDEP Division of Waste Management – Underground Storage Tanks, Ms. Nancy Tanner
- KDEP Division of Water, Ms. Erin Martin

We reviewed KDEP files for the following sites:

- Speedway SuperAmerica
- Ken Towery Tire Center
- Kenwood Service Center
- Goodyear Kaiser Tire Center
- Rite Aid Drug Store
- Auburndale Auto Parts
- Southside Louisville Body Shop
- Payday Advance
- Valvoline Instant Oil

We also sent letters to the following additional local sources of potential environmental information:

- Louisville Metro Air Pollution Control District, Mr. Doug Spillman
- Louisville Metro Health Department, Ms. June Kelly-Roy

Copies of the letters and the responses are attached in Appendix D.

3. UST/Hazardous Material Review Findings

Based on our preliminary overview approximately 13 sites were identified as having current or previous activities associated with petroleum or other chemical usage. A summary of each of these sites is included in Appendix B). These sites have either had limited quantity usage active USTs still in use, or have had USTs removed from the property.

Records indicate that USTs have been removed from the following sites:

- | | |
|------------------------------|-------------------------------------|
| • Speedway SuperAmerica | 13 USTs removed in 1998 |
| • Ken Towery Tire Center | 1 UST removed prior to 1991 |
| • Kenwood Service Center | 4 USTs removed (1 UST remaining) |
| • Goodyear Kaiser Center | 1 UST removed in 1999 |
| • Rite Aid Drug Store | 3 USTs removed in 1998 |
| • South Louisville Body Shop | 3 USTs removed in 1998 |
| • Payday Advance | 5 USTs removed prior to 2004 |
| • BP Oil | 2 USTs remain on site |
| • Valvoline Instant Oil | Oil/water separator remains on site |

Four sites appear to have a higher potential for encountering soil contamination from petroleum storage on the site. While several of the above sites have received No Further Action Letter, this does not rule out the possibility of contamination being encountered. The site involving dry cleaning activities also should be considered as a potential source of contamination, however limited information was available.

1. Kenwood Service Center – 6903 Southside Drive – This property was apparently an old service station. An Additional Information Report submitted to the KDEP in August 2003 reported contamination exceeding allowable cleanup levels.
2. Payday Advance – 7101 Southside Drive – This site was formerly a JJ Food Mart. Based on a report submitted to KDEP in July 2004, "It appears that additional investigation will be required to define the extent of groundwater impact. Two monitoring wells were noted on this site approximately 25 feet from the edge of pavement."
3. BP Oil Company – 5469 New Cut Road – This site is currently vacant. Louisville Metro Health logged a complaint in April 1999 regarding a sheen and diesel smell in a Louisville Water Company pipe trench.
4. Valvoline Instant Oil – 7401 Third Street – This site apparently had an oil water separator discharge into the storm sewer for a period of time. This site may not be included in the proposed construction.

Several of the facilities have active underground storage tanks; however, they do not appear to be close enough to the roadway to cause a conflict. The Speedway Store has a tank pit located approximately 50 feet from the edge of pavement. The USTs for the Speedway SuperAmerica at Strawberry Lane are behind the building.

4. Conclusions

A preliminary UST/Hazardous Materials overview has been performed for the proposed Southside Drive Road widening project. A relatively large number of properties were identified as having current or past usage of these materials. Several properties along the northern portion of the alignment from National Turnpike to Strawberry Lane appear to have a potential for encountering soil contamination, as well as property at the New Cut/Southside Drive intersection. We recommend that additional evaluation be conducted at these locations.

Our review is based solely upon readily available information. No warranties or certifications are provided by FMSM concerning the existence or absence of contamination on or affecting the property. Such warranties cannot be provided because it is not possible to identify the existence or absence of contamination with that degree of certainty.

Figures



EDR DataMap - Corridor Study Southside Dr Roadway Widening

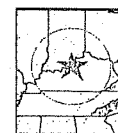

Louisville, KY

- | | | | | |
|--|---------------|-------------|-------------------------|----------|
| Listed Sites | Major Roads | Pipelines | Superfund Sites | Wetlands |
| Earthquake Epicenters (Richter 5 or greater) | Waterways | Powerlines | Federal DOD Sites | |
| Search Boundary | Railroads | Fault Lines | Indian Reservations BIA | |
| Roads | Contour Lines | Water | 100-Yr Flood Zones | |

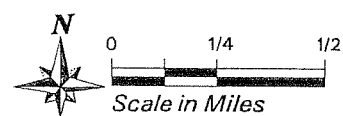

**SUPERAMERICA - 7400 3RD STREET ROAD
ABANDONED RP - 5469 NEW CUT ROAD**

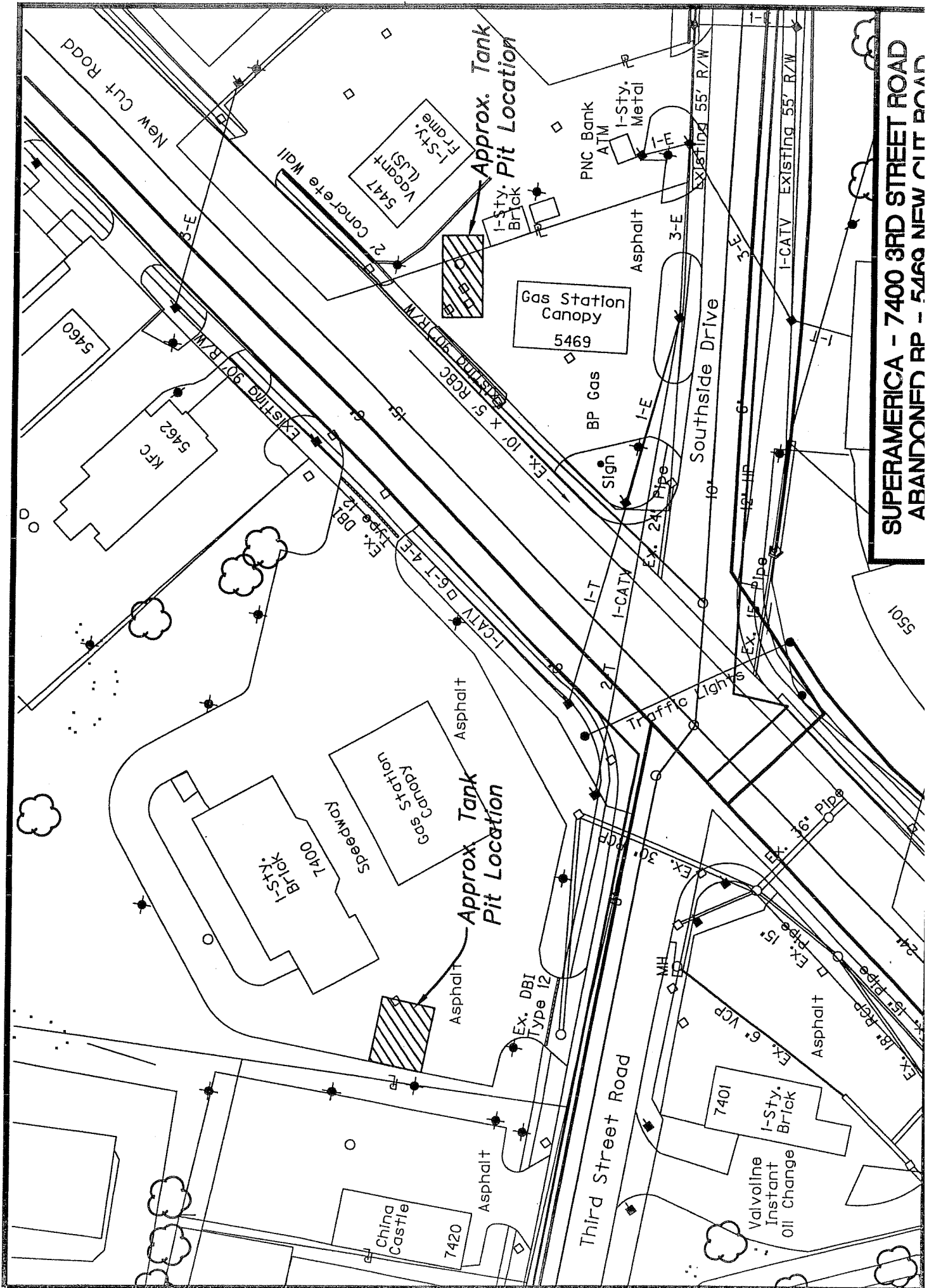

SPEEDWAY SUPERAMERICA
6821 SOUTHLINE DRIVE

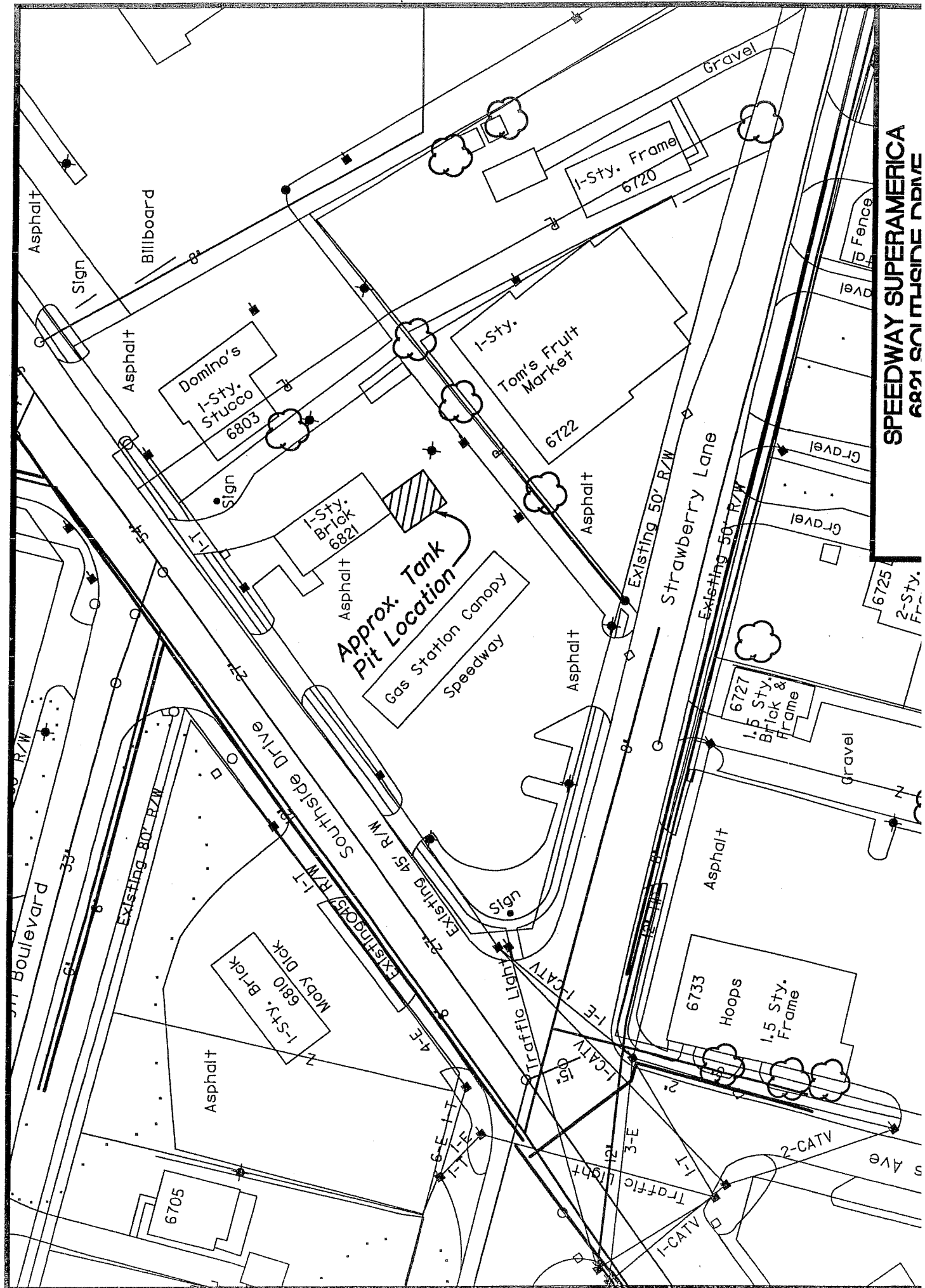

Summary of Sites of Interest

**Southside Drive Roadway Widening
Environmental Sites of Interest**
(Listed By Parcel Number)

37R. Speedway SuperAmerica

6821 Southside Drive
Louisville, KY 40218
(502) 366-8338

Business and Land Owner: Speedway SuperAmerica LLC

Contact: John Helms

Phone: (937) 864-3000

Databases: RCRIS-SQG, FINDS, UST

Summary:

Underground storage tanks on the property. Four tanks are currently active and being used by Speedway SuperAmerica. Three underground storage tanks have been removed and removal was verified. Ten tanks have been abandoned or newly discovered. This site is a small quantity generator of hazardous waste.

33L. Southside Cleaners (*Previously Paxtons Charlie One Hr Dry Cleaning*)

6920 Southside Drive
Louisville, KY 40214

Land Owner: Vinh Dang & Trung N. That

Phone:

Databases: RCRIS-SQG, FINDS

Summary:

This site is a small quantity generator of hazardous waste.

35R. Ken Towery Tire Center (*Previously Marvins Tire Center*)

6919 Southside Drive
Louisville, KY 40214

Land Owner: Ken Towery's Auto Care Supercenter

Database: UST

Summary:

On this property there is a 100 gallon underground storage tank that is used for the containment of used oil.

35R. Kenwood Service Center (*looks like abandoned BP station*)

6903 Southside Drive
Louisville, KY 40214

Owner: Kenwood Service Center

Contact: (502) 245-6437

Databases: RCRIS-SQG, FINDS, UST, SB193

Summary:

Four underground storage tanks have been removed from the site and removal was verified. There is one abandoned underground storage tank located on the property. This site is a small quantity generator of hazardous waste. SB193 indicates that the facility has performed permanent closure activities and have known soil contamination. Site is not currently being used for business.

32L. GoodYear Kaiser Tire Center

7000 Southside Drive
Louisville, KY 40214

Owner: Aaron & Kathleen Walters

Database: UST

Summary:

One 250 gallon underground storage tank was removed from the site and the removal was verified.

22L. Rite Aid Drug Store (*previously Southside Automotive*)

7118 Southside Drive
Louisville, KY 40214

Owner: Rite Aid of Kentucky, Inc.

Database: UST

Summary:

Southside Automotive is no longer on this site. Site is currently a Rite Aid Drug Store. Three underground storage tanks were removed and the removal was verified.

24L. Auburndale Auto Parts & Machine Shop, Inc.

7114 Southside Drive
Louisville, KY 40214

Owner: Auburndale Auto Parts & Machine Shop, Inc.

Database: ERNS, HMIRS

Summary:

Facility has reported emergency releases to the soil. 55 gallon drum fell off the back of truck while it was being loaded with lift gate.

28R. South Louisville Body Shop

7105 Southside Drive
Louisville, KY 40214

Owner: Charles E. Walker, Inc.

Database: UST

Summary:

Three underground storage tanks have been removed from the site and removal was verified.

29R. Payday Advance (*previously JJ Food Mart*)

7101 Southside Drive
Louisville, KY 40214

Owner: William T. Etscorn

Phone: (502) 4912637

Database: SB193, UST

Summary:

Five underground storage tanks have been removed from the property. Another 99 gallon underground storage tank for fuel oil may still be in place. SB193 indicates that the facility has performed permanent closure activities. Site has known soil contamination. Site is currently being used as a cash advance business.

2L. BP Oil Co. (Gulf Food Company) – *Out of Business*

5469 New Cut Road
Louisville, KY 40214

Owner: BP Oil Company

Contact: Terry Blackburn

Phone: (502) 774-4431

Databases: RCRIS-SQG, FINDS

Summary:

This site is not currently being used for business. Site is a small quantity generator of hazardous waste.

1R. Valvoline Instant Oil Change

7401 3rd Street Road
Louisville, KY 40214

Owner: Lillian S. Fitzgibbon

Phone: (606) 264-2271

Contact: James Evans

Phone: (606) 264-2271

Database: RCRIS-SQG, FINDS

Summary:

This site is a small quantity generator of hazardous waste.

25R. Captain D's (*previously a car wash*)

7131 Southside Drive
Louisville, KY 40214

Owner: US Restaurant Properties Operating LP

Summary:

Current restaurant site was previously the site of a do-it-yourself car wash.

1L. SuperAmerica

7400 3rd Street Road
Louisville, KY 40214

Business and Land Owner: Speedway SuperAmerica LLC

Contact: John Helms

Phone: (937) 864-3000

Summary:

Site is currently a SuperAmerica gas station. This site is outside of the project boundary.

Photographs

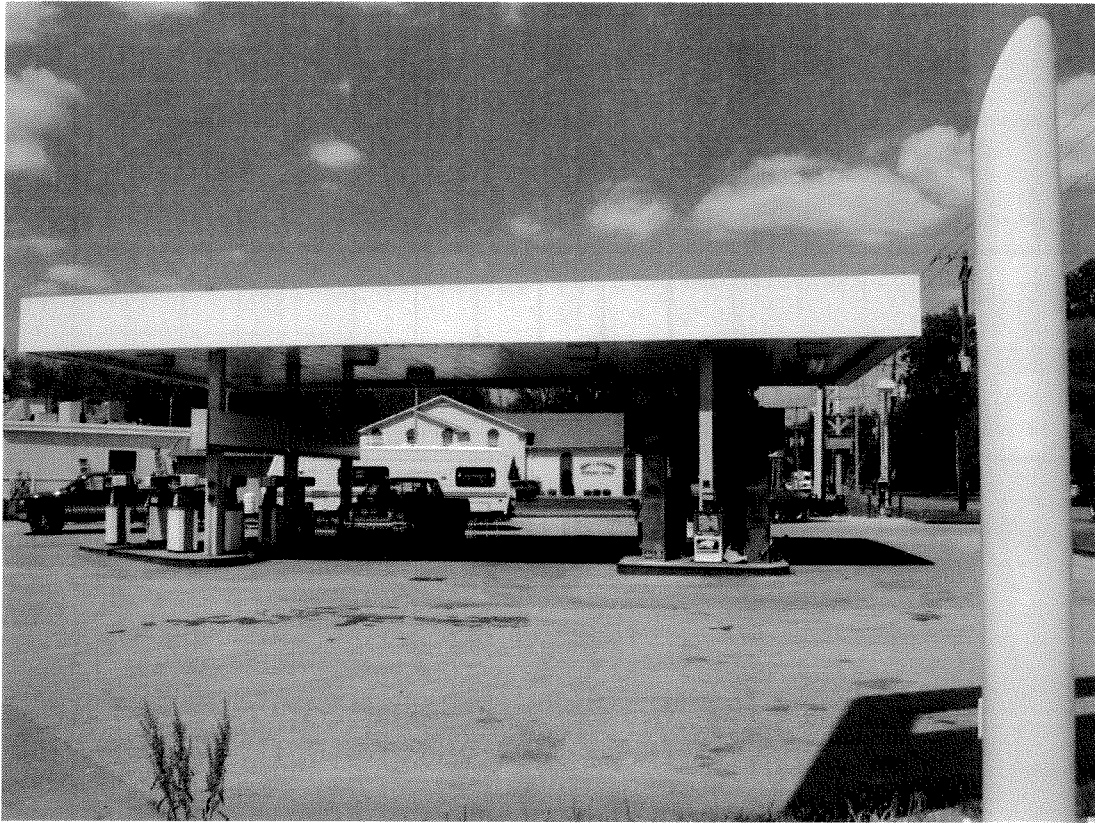

5469 New Cut Road – Former BP Oil Company



6821 Southside Drive – Speedway SuperAmerica Station



7101 Southside Drive – Payday Advance (previously JJ Food Mart)



7401 3rd Street Road – Valvoline Instant Oil Change



7400 3rd Street Road – Speedway SuperAmerica Station

Photo Taken 5/4/05

Documentation



MERIT ENVIRONMENTAL, INC.

July 9, 2004

ORIGINAL

Underground Storage Tank Branch
Kentucky Division of Waste Management
14 Reilly Road
Frankfort, Kentucky 40601

Re: Additional Evaluation
JJ Food Mart
7101 Southside Drive
Louisville, Kentucky
Facility ID. No. 9795-056
Project No. 322

RECEIVED
2004 JUL 12 P 1:08
KY DIV. OF WASTE MGMT
U.S.T. BRANCH

Dear Sir or Madam:

On behalf of our client, William Etscorn, Merit Environmental, Inc. is submitting the enclosed Additional Evaluation report. The activities conducted as part of the Additional Evaluation are in response to a request from the Division of Waste Management.

The activities conducted as part of this investigation included the advancement of five soil borings, the conversion of four borings to monitor wells, and the collection and analysis of groundwater and soil samples for laboratory analysis.

If you have any questions or comments regarding this Additional Evaluation, please contact our office at (502) 240-0405.

Sincerely,
Merit Environmental, Inc.

Lisa Baxter
Environmental Scientist

Additional Evaluation

**JJ Food Mart
7101 Southside Drive
Louisville, Jefferson County, Kentucky
Facility ID No. 9795-056
Project No. 322**

Prepared for:

**William Etscorn
3933 Bardstown Road
Louisville, Kentucky 40218**

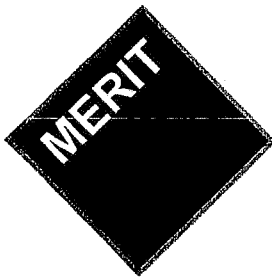

**MERIT ENVIRONMENTAL, INC.
P.O. Box 436768
Louisville, Kentucky 40253-6768**

July 9, 2004

Table of Contents

1.0	<u>Introduction</u>	1
2.0	<u>Background</u>	2
3.0	<u>Soil Borings</u>	6
4.0	<u>Well Installation</u>	8
5.0	<u>Surveying and Gauging</u>	9
6.0	<u>Groundwater Sample Collection</u>	11
7.0	<u>Laboratory Analysis</u>	11
	7.1 Soil Sample Analysis	11
	7.2 Groundwater Sample Analysis	13
8.0	<u>Discussion of Results</u>	14
9.0	<u>Conclusions</u>	15
Appendix A	Additional Evaluation Request Letter	
Appendix B	Soil Boring Logs	
Appendix C	Well Construction Diagrams	
Appendix D	Laboratory Reports/Chain of Custody	
Appendix E	AE Checklist/Request Letter	

1.0 Introduction

Merit Environmental, Inc. conducted the Additional Evaluation documented in this report to further evaluate soil and groundwater conditions at J.J. Food Mart, Louisville, Kentucky.

This investigation was conducted in response to the Additional Evaluation request letter from the Kentucky Division of Waste Management dated February 12, 2002.

The facility is described as follows:

**JJ Food Mart
7101 Southside Drive
Louisville, Kentucky
UST ID #9795-056**

The facility is owned by:

**William Etscorn
3933 Bardstown Road
Louisville, Kentucky 40218
(502) 491-2639**

The site is located along the east side of Southside Drive to the north of National Turnpike and directly across from the intersection with Hatcher Drive. The general location of the site is shown in Figure 1. Land use in the surrounding area is a mixture of residential and commercial sites.

The subject facility historically served as a service station and convenience store. Three underground storage tanks were removed from the facility in the fall of 2001. Soil and groundwater impacts were detected in the tank excavation during the closure.

The Kentucky Division of Waste Management issued an Additional Evaluation Request as a result of the impacts detected during the closure activities. A copy of the request letter is included in Appendix A. The request included the installation of four monitor wells in the area around the former tank excavation and the collection and analysis of soil and groundwater samples.

The following sections of this report document the procedures and results of the additional evaluation.

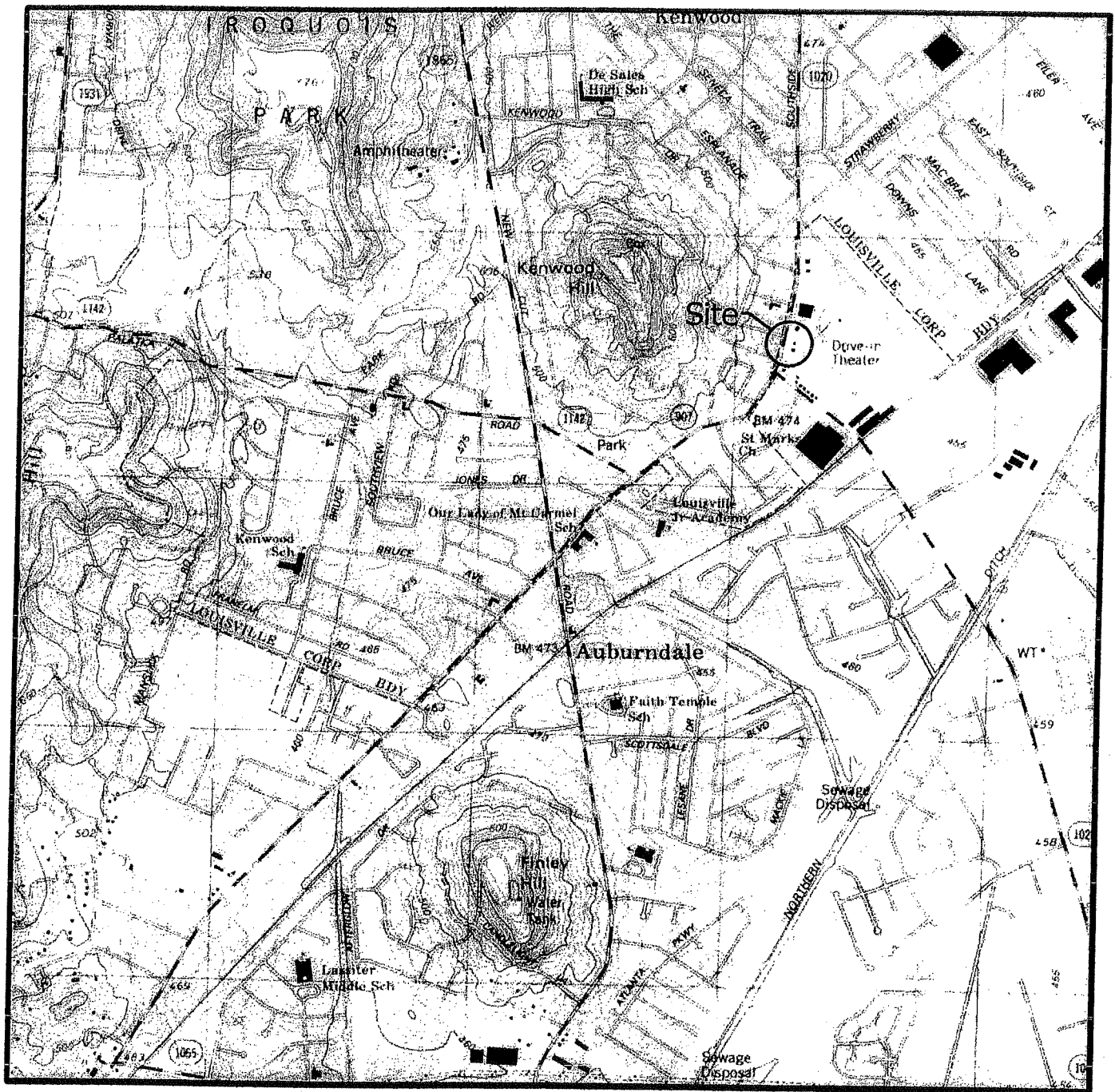

North

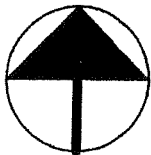

Source:

USGS - Louisville West, KY Quadrangle
1983 Revised 1994

Figure 1: Site Location
JJ Food Mart
7101 Southside Drive
Louisville, Kentucky

MERIT ENVIRONMENTAL, INC.
P.O. Box 436768
Louisville, Kentucky 40253-6768
(502) 240-0405

2.0 Background

The previous petroleum installation at the site consisted of one 10,000 gallon, gasoline tank, one 6,000-gallon and one 4,000 gallon underground storage tank. A diagram showing the layout of the former tank installation is provided in Figure 2. On October 30 and November 1, 2001, the three tanks and the associated piping were excavated and removed from the ground. As part of the closure activities, soil and groundwater samples were collected from the tank excavation and pipe trench. The soil and groundwater samples were analyzed for benzene, toluene, ethylbenzene, xylenes, and polynuclear aromatic hydrocarbons. The laboratory results for the soil samples from the tank excavation and pipe trench are summarized in Table 1. Laboratory results for the water in the tank excavation are summarized in Table 2.

As part of the closure, the facility was classified based on the characteristics of the site and surrounding area in order to determine the closure criteria. The classification of the facility determined that the soil and groundwater must meet the levels established in Class III-Table I and Groundwater Table 1.

The concentration of benzene detected in the water sampled from the tank excavation exceeded the Groundwater Table 1 Closure Criteria. During the closure activities a total of 9,000 gallons of water was removed from the excavation for off-site disposal. The water was removed to address the impacts and to permit the backfilling of the excavation.

One of the soil samples initially collected from the pipe trench (pipe trench-west) exceeded the Class III-Table I closure criteria. The samples collected from all of the other areas of the pipe trench and tank excavation met the closure criteria. The impacts identified in Pipe Trench-West were addressed by excavation and landfill disposal immediately following the closure activities. The closure samples collected following the removal of the impacted soil met the allowable levels.

Following the soil remediation activities conducted during closure activities, soils at the site appeared to meet the Class III-Table I closure criteria.

The Kentucky Division of Waste Management requested the investigation documented in the following sections as a result of the groundwater impacts detected during the closure activities.

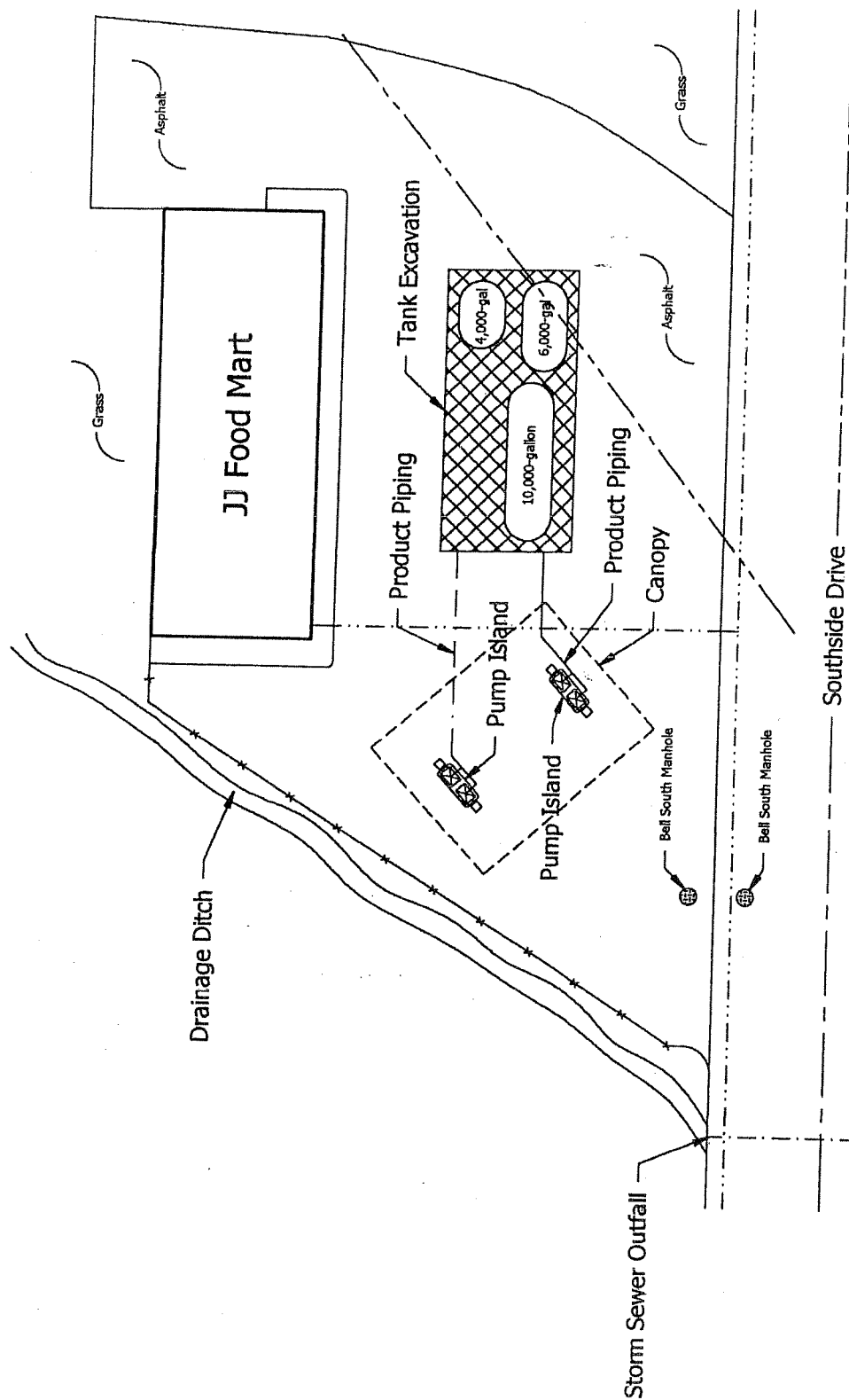
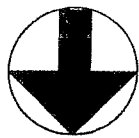

Figure 2: Site Diagram

JJ Food Mart
7101 Southside Drive
Louisville, Kentucky

MERIT ENVIRONMENTAL, INC.
P.O. Box 436768
Louisville, Kentucky 40253-6768
(502) 240-0405

Table 1
Laboratory Analytical Results-Soil
October 31, 2001
JJ Food Mart
7101 Southside Drive
Louisville, Kentucky

Sample ID	Concentration (milligrams per kilogram)				
	Benzene	Toluene	Ethylbenzene	Xylenes	PAHs
North Wall	0.0030	BDL	BDL	BDL	BDL
East Wall 1	0.28	0.13	0.20	0.16	Napthalene= 0.35 all other PAHs=BDL
East Wall 2	0.030	BDL	0.084	0.25	BDL
West Wall 1	0.055	BDL	0.16	0.58	Napthalene=0.82 all other PAHs=BDL
West Wall 2	0.058	BDL	0.18	0.64	BDL
Bottom1	BDL	BDL	BDL	BDL	BDL
Bottom 2	BDL	BDL	BDL	BDL	BDL
South Wall	0.026	BDL	0.052	0.20	BDL
Pipe Trench East	0.78	1.9	2.8	16.0	Napthalene=3.3 all other PAHs=BDL
Pipe Trench West	6.9	45.0	19.0	100.0	Napthalene=9.2 all other PAHs=BDL
Pump Island East	0.063	BDL	0.19	0.76	BDL
Pump Island West	0.50	BDL	1.6	10.0	Napthalene=2.8 all other PAHs=BDL
Stockpile	BDL	BDL	0.66	2.6	BDL
Collection Date November 28, 2001					
Pipe Trench West*	0.23	4.1	3.8	23.0	Napthalene=0.78, all other PAH's=BDL
Closure Criteria	2	18	30	50	Napthalene=5.0 Chrysene=15.0 B(a)A=0.15 cPAH=0.3 nPAH=10

BDL= Below Detection Limits

PAH's=Polynuclear Aromatic Hydrocarbons

*Collected following removal of impacted soil.

B(a)A=Benzo(a)anthracene

cPAH=Carcinogenic polynuclear aromatic hydrocarbons

nPAH=Non-carcinogenic polynuclear aromatic hydrocarbons

Table 2
Laboratory Analytical Results-Water
October 31, 2001
JJ Food Mart
7101 Southside Drive
Louisville, Kentucky

Sample ID	Concentration (milligrams per kilogram)				
	Benzene	Toluene	Ethylbenzene	Xylenes	PAHS
Tank Excavation Water	0.25	0.46	0.051	0.30	Napthalene=0.024 All other PAHs=BDL
Closure Criteria	0.005	1.0	0.7	10.0	cPAH=0.005 nPAH=3.0 Napthalene=0.3

cPAH=Carcinogenic polynuclear aromatic hydrocarbons.

nPAH=Non-carcinogenic polynuclear aromatic hydrocarbons.

3.0 Soil Borings

As directed by the Kentucky Division of Waste Management, Merit Environmental, Inc. advanced four soil borings for the collection of soil samples and the installation of four monitor wells (MW-1 through MW-4) on May 20th 2003. The borings were installed to further assess subsurface conditions in the area of former tank pit. The locations of the boring wells are shown in Figure 3.

A truck mounted drill rig and 4.25-inch hollow stem augers advanced the soil borings for the collection of soil samples and the installation of the monitor wells. Prior to advancing the borings, the augers and drilling equipment were decontaminated with the high-pressure wash. Each soil boring was advanced to auger refusal which occurred at a depth of approximately 14 feet. One additional boring, PT-1, was advanced to a depth of four feet in the area of the former pipe trench. This boring was advanced to permit the collection of a soil sample to confirm the laboratory results for the sample previously collected from the pipe trench.

The drilling crew used split spoon soil samplers to collect soil samples from each soil boring. The drilling crew washed the split spoon samplers with detergent and water followed by rinses with alcohol and distilled water prior to collecting each sample.

Merit Environmental, Inc. maintained a soil boring log describing the subsurface lithologies for the soil boring. Copies of the soil boring logs are included in Appendix B. The soils encountered in the boring were primarily described as gray and mottled silty clay.

The soil samples from each boring were placed in four ounce glass jars with teflon lined lids. Each sample container was labeled with the project name, sample ID and the date and time of collection. The samples were stored in an iced cooler for shipment to the laboratory. Chain of custody records were maintained for each sample submitted for laboratory analysis.

Field headspace analyses were conducted for each of the soil samples using a MiniRae Photoionization Detector (PID). Prior to conducting the analyses, the PID was calibrated following the manufacturer's instructions using 100 parts per million isobutylene. The results of the headspace analysis are included on the boring log.

Three soil samples from each boring were selected for laboratory analysis. The samples were selected based on the collection depths, results of the headspace analysis and the physical observations made during the drilling activities.

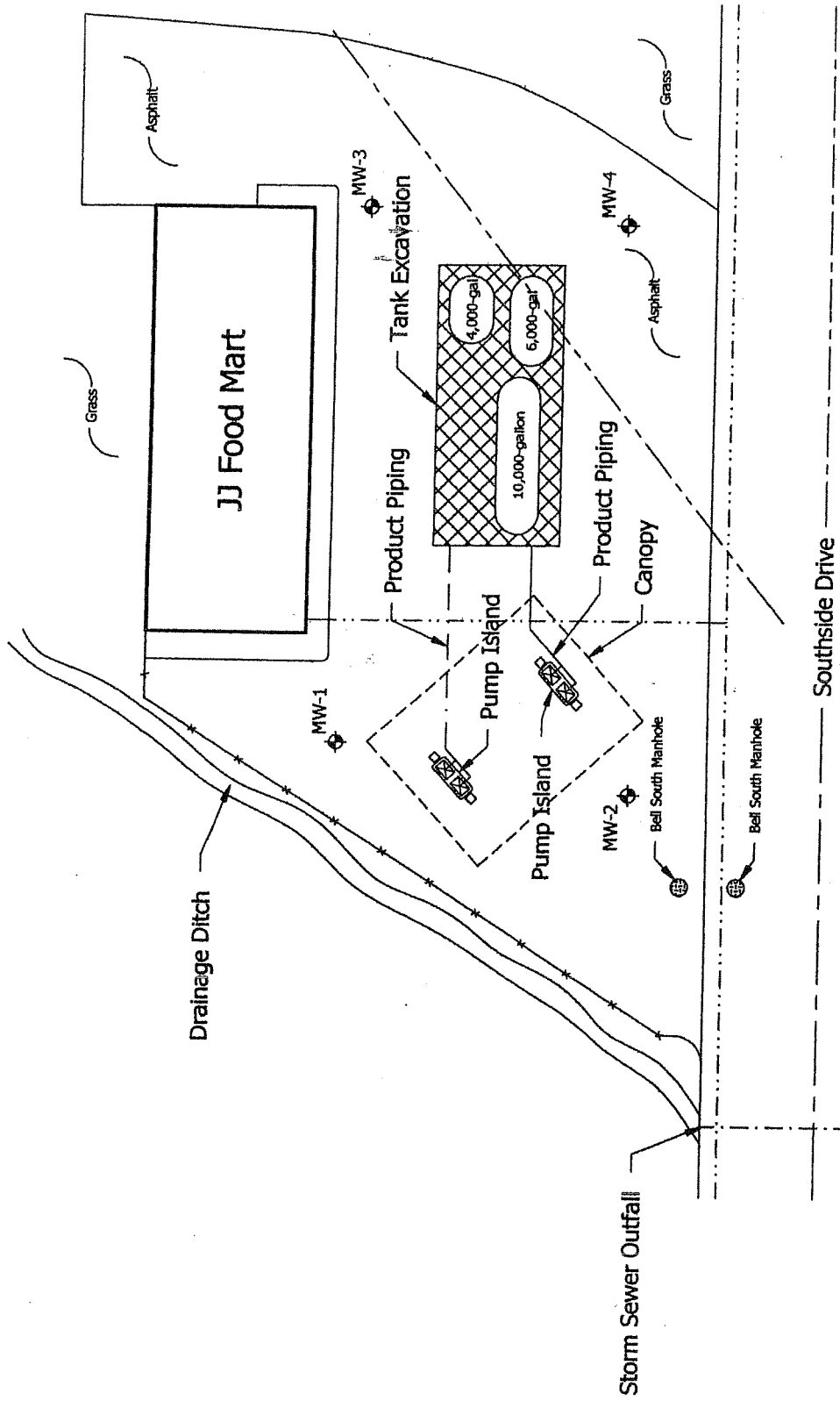

Legend

- = Storm Sewer
- = Water Line
- = Overhead Electric
- = Product Piping
- = Center Line - Road
- ▤ = Tank Excavation

Figure 3: Well Locations

JJ Food Mart
7101 Southside Drive
Louisville, Kentucky

MERIT ENVIRONMENTAL, INC.
P.O. Box 436768
Louisville, Kentucky 40253-6768
(502) 240-0405

4.0 Well Installation

Four groundwater monitoring wells, MW-1 through MW-4 were installed in the borings advanced as part of this project.

The monitor wells were constructed of two inch diameter PVC. The wells consisted of approximately 10 feet of factory slotted well screen and 3.5 feet of riser. A filter pack of coarse silica sand was placed around the screened interval in the well. The filter pack was extended approximately six to twelve inches above the top of the screen interval. A bentonite seal approximately two feet thick was placed above the top of the filter pack. The remainder of the annular space was filled with cement grout.

Flush mount steel covers were installed above the monitor wells. The cover was set in two feet square concrete pads. The tops of each well casing were fitted with locking security caps.

Diagrams showing the construction of the wells are provided in Appendix C.

Upon completion, the wells were developed by surging and bailing to ensure communication with the water bearing zone. The development water was placed in a 55-gallon drum and stored on site for subsequent disposal.

5.0 Surveying and Gauging

The four newly installed wells were surveyed to determine the relative elevations of the well casings. During the gauging event, Merit Environmental, Inc. measured the depth to groundwater in each well using an electronic water level indicator. The gauging data was then combined with the survey data to calculate the relative groundwater elevations for each well and to estimate the direction of groundwater flow. The survey and gauging data is presented in Table 3.

Table 3
Relative Groundwater Elevations
JJ Food Mart
June 4, 2003
Louisville, Kentucky

Sample Location	Relative Casing Elevation (feet)	Depth to Groundwater (feet)	Relative Groundwater Elevation
MW-1	98.60	5.83	92.77
MW-2	98.35	6.12	92.23
MW-3	98.45	5.45	93.00
MW-4	98.10	4.81	93.29

Based on the survey and gauging data groundwater at the site appears to be flowing to the north. Potentiometric surface map showing the estimated direction of groundwater flow is provided in Figure 4.

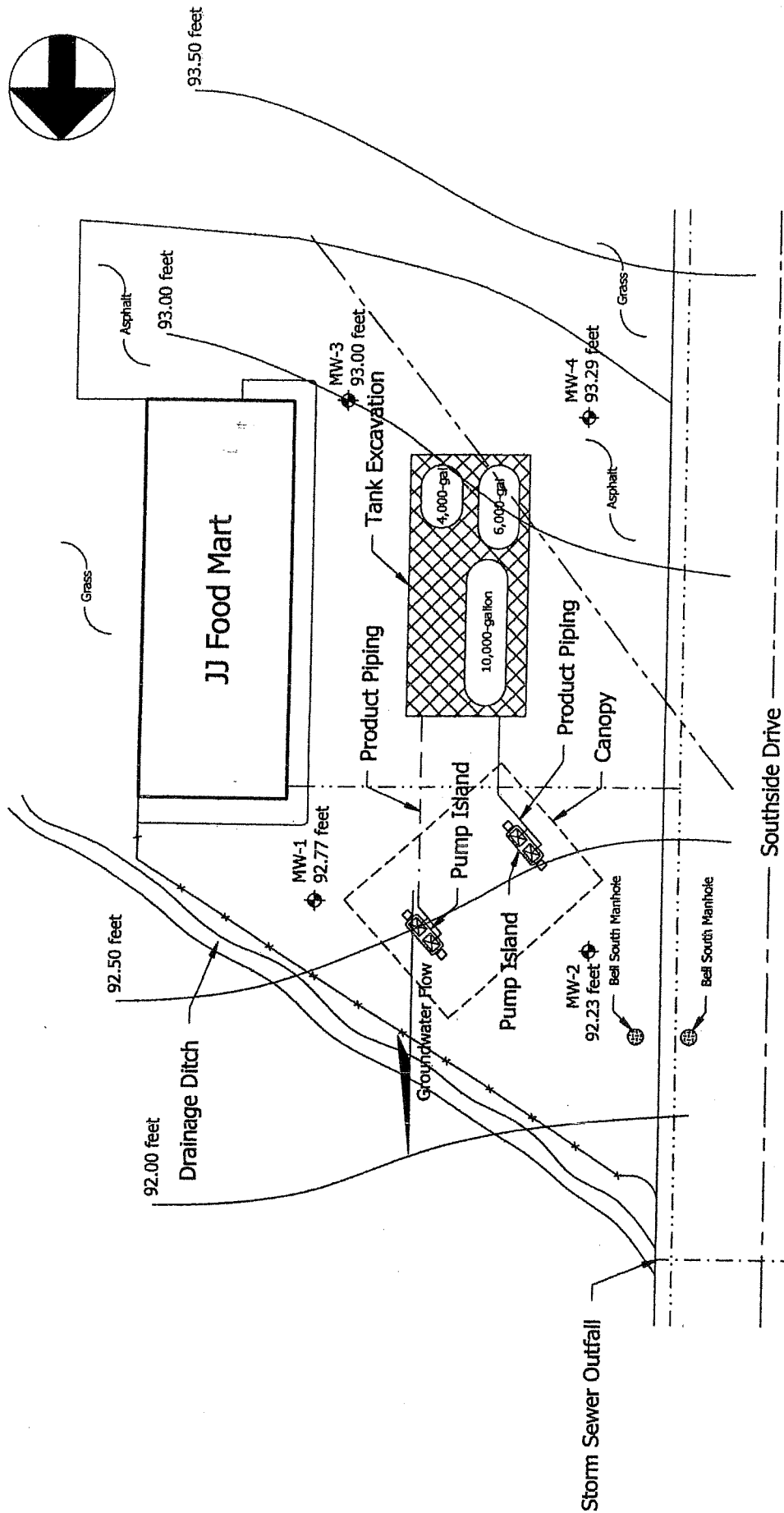

Figure 4: Potentiometric Surface
JJ Food Mart
7101 Southside Drive
Louisville, Kentucky

MERIT ENVIRONMENTAL, INC.
 P.O. Box 436768
 Louisville, Kentucky 40253-6768
 (502) 240-0405

- Legend
- = Storm Sewer
 - = Water Line
 - = Overhead Electric
 - = Product Piping
 - = Center Line - Road
 - ▨ = Tank Excavation

6.0 Groundwater Sample Collection

On June 4, 2003, Merit Environmental Inc. collected groundwater samples from the four wells installed as part of this project. Prior to collecting the samples, the wells were purged by removing approximately three well volumes of water. The water was placed in a 55-gallon drum and stored on site for subsequent disposal.

The field technicians used disposable plastic bailers to collect a groundwater samples from each of the wells. The samples were placed in 40-milliliter glass vials which had been preserved with hydrochloric acid. The sample containers were labeled with the project name, sample ID and the date and time of collection. The groundwater samples were stored in an iced cooler for shipment to the laboratory. Chain of custody records were maintained for each water sample submitted for analysis.

7.0 Laboratory Analysis

The soil and groundwater samples collected during this project were submitted to Environmental Science Corporation in Mt. Juliet, Tennessee for laboratory analysis.

7.1 Soil Sample Analysis

The laboratory analyzed each of the soil sample for benzene, toluene, ethylbenzene, xylenes by SW846 Method 8021B, and polynuclear aromatic hydrocarbons by SW846 Method 8270C. The laboratory results for the soil samples are summarized in Table 4. A copy of the laboratory report for the soil samples is included in Appendix E.

7.2 Groundwater Sample Analysis

The groundwater samples collected from the newly installed wells were analyzed for benzene, toluene, ethylbenzene, xylenes by SW846 Method 8021B, and polynuclear aromatic hydrocarbons by SW846 Method 8270C. The results of the laboratory analysis for the groundwater samples are presented in Table 3. Copies of the laboratory report for the groundwater samples are included in Appendix D. A site diagram presenting the groundwater sample results is included in Figure 5.

Table 5
Groundwater Sample Results
May 4, 2003
JJ Food Mart
7101 Southside Drive
Louisville, Kentucky

Sample ID	Concentration (milligrams per liter)				
	Benzene	Toluene	Ethylbenzene	Xylenes	PAH's
MW-1	0.31	0.048	0.095	0.30	Napthalene= 0.0068, all other PAH's= BDL
MW-2	0.041	BDL	0.048	0.043	Napthalene= 0.0067, all other PAH's=BDL
MW-3	BDL	BDL	BDL	BDL	BDL
MW-4	BDL	BDL	BDL	BDL	BDL
Closure Criteria	0.005	1.0	0.7	10.0	Napthalene=0.3

BDL=Below Detection Limits
Bold=Exceeds closure criteria

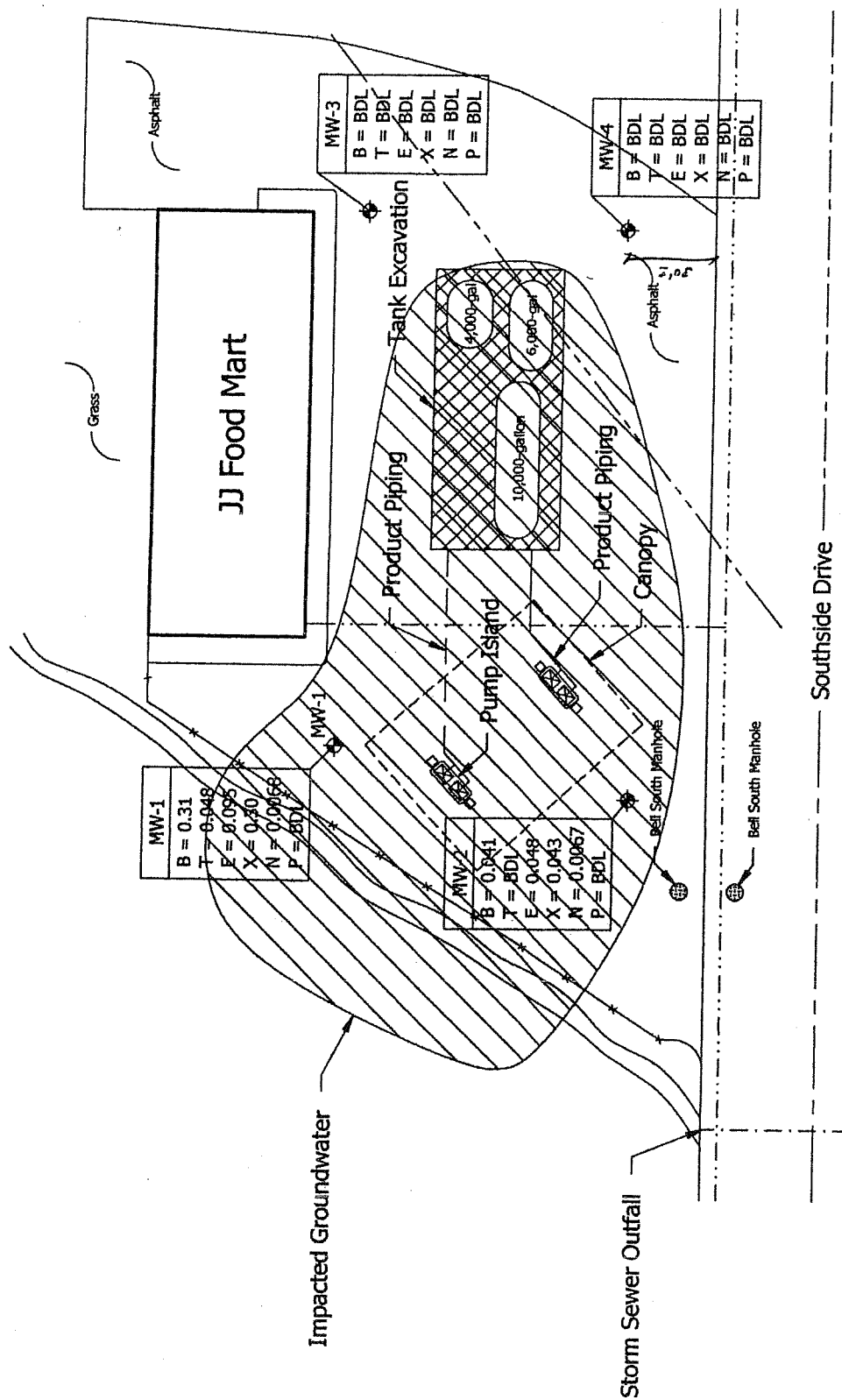

Figure 5: Groundwater Impacts

JJ Food Mart
7101 Southside Drive
Louisville, Kentucky

MERIT ENVIRONMENTAL, INC.
P.O. Box 436768
Louisville, Kentucky 40253-6768
(502) 240-0405

8.0 Discussion of Results

During the previous underground storage tank closure activities, this facility was classified in accordance with 401KAR42:080 to determine the clean up criteria for soil and groundwater. According to the classification soils at this facility must meet the levels established in Class III Table 1. Groundwater must meet the levels established in Groundwater Table 1.

Class III - Table 1 establishes soil closure criteria of 2 mg/kg of benzene, 18 mg/kg of toluene, 30 mg/kg of ethylbenzene, 50 mg/kg of xylenes, 15 mg/kg of chrysene, 0.15 of benzo(a)anthracene, 0.3 mg/kg of carcinogenic PAH's, 10 mg/kg of noncarcinogenic PAH's, and 5.0 mg/kg of naphthalene.

All thirteen of the soil samples collected from the five borings advanced as part of this project met the Class III-Table 1 closure criteria. Groundwater Table 1 establishes groundwater cleanup criteria of 0.005 mg/l of benzene, 1.0 mg/l of toluene, 0.7 mg/l of ethylbenzene, 10.0 mg/l of xylenes, 0.005 mg/kg of carcinogenic polynuclear aromatic hydrocarbons, 3.0 mg/kg of non-carcinogenic polynuclear hydrocarbons, and 0.3 mg/kg of naphthalene. The groundwater samples collected from wells MW-1 and MW-2 exceeded the closure criteria for benzene. The groundwater samples collected from wells MW-3 and MW-4 met the closure criteria.

Based on the results for the soil and groundwater samples collected as part of this project, it appears that additional investigations will be necessary to define the extent of the groundwater impacted in the areas of wells MW-1 and MW-2.

The soil samples submitted for laboratory analysis as part of this project met the closure criteria for benzene, toluene, ethylbenzene, xylenes and polynuclear aromatic hydrocarbons.

9.0 Conclusions

As requested by the Division of Waste Management, Merit Environmental, Inc. conducted an Additional Evaluation of JJ Food Mart in Louisville, Kentucky. The assessment was conducted to further evaluate subsurface conditions in the area near the former tank excavation.

During the previous tank closure activities, water was encountered in the tank excavation. The sample collected from the water exceeded the closure criteria for benzene. As a result, the Division of Waste Management requested the installation of four monitor wells to further evaluate subsurface conditions.

The activities conducted as part of this investigation included the advancement of five soil borings, the conversion of four borings to monitor wells, and the collection and analysis of groundwater and soil samples for laboratory analysis.

All of the soil samples collected as part of this project met the closure criteria for benzene, toluene, ethylbenzene, xylenes and polynuclear aromatic hydrocarbons. The groundwater samples collected from monitor wells MW-1 and MW-2 exceeded the closure criteria for benzene. The groundwater samples collected from the other wells met the closure criteria.

Based on these results, it appears that additional investigations will be required to define the extent of the groundwater impacts in the areas of MW-1 and MW-2.

A copy of the Additional Evaluation checklist is included in Appendix E.

Additional Evaluation Request Letter

JAMES E. BICKFORD
SECRETARY



JS Food Mart
#322
PAUL E. PATTON
GOVERNOR

COMMONWEALTH OF KENTUCKY
NATURAL RESOURCES AND ENVIRONMENTAL PROTECTION CABINET
DEPARTMENT FOR ENVIRONMENTAL PROTECTION
FRANKFORT OFFICE PARK
14 REILLY RD
FRANKFORT KY 40601

Additional Evaluation I Request Letter

February 12, 2002

WILLIAM ETSCORN
3933 BARDSTOWN RD
LOUISVILLE KY 40218

RE: J J Food Mart
7101 Southside Dr
Louisville- Jefferson County
UST ID#: 9795-056
ERT#: none

Dear Mr. Etscorn:

Division of Waste Management personnel have performed a review of the Closure Assessment report for tanks #3, #4, and #6 submitted by Merit Environmental on behalf of William Etscorn.

This site is being reviewed under current regulations: Class III Soil Table I and Groundwater Table 1 allowable levels. The reports indicate that BTEX constituents exceeding Groundwater Table 1 were found in the pit. This indicates the necessity for additional evaluation of the site.

Therefore, under the authority of Kentucky Revised Statute 224.60-105 and 401 Kentucky Administrative Regulation 42:070, the Division is requesting that William Etscorn conduct the following Additional Evaluation Grid-Based Sampling (AEI) procedures. This request is necessary in order to expedite the review of this site by the Underground Storage Tank (UST) Branch and the Office of Petroleum Storage Tank Environmental Assurance Fund (OPSTEAF). This request is based upon the site map available for this site. You must verify the accuracy of the map upon which this request is based prior to initiating any site work.

1. Complete and submit the attached AE Checklist to the UST Branch.
2. Collect soil samples, convert the borings to monitoring/assessment wells and collect groundwater samples from blocks E14, F8, P9, and P14 according to the attached Requested Sampling Location Map at the following intervals for soil: 3-8 ft, 8-13 and 13-18 ft or to bedrock, whichever is encountered first. If bedrock is encountered, collect a soil sample at the soil/bedrock interface. Analyze these samples for BTEX and PAH constituents. Determine the direction of groundwater flow.
3. Collect all soil and/or groundwater samples in accordance with the attached Drilling, Sampling, Maps, and Safety Procedures.
4. The maximum holding time of 14 days was exceeded for the PAH analysis on sample PT West collected on 11/27/01. Re-sample this area of the pipe trench and analyze for PAH constituents.
5. The chain of custody for the soil samples collected on 10/31 and 11/1 2001 is incomplete. On what date and at what time did George Munich relinquish the samples? Did anyone else have custody of the samples prior to their relinquishment to Fed Ex?
6. Page 14 of the laboratory report for indicates that benzene in sample East I is "Greater than upper calibration limit-Actual value is known to be greater than the upper calibration range." Is the benzene level in this sample estimated? Does this sample meet requirements for closure under Class III Soil Table I levels? Provide a statement from the lab if appropriate.



Printed on Recycled Paper
An Equal Opportunity Employer M/F/D

7. The laboratory report indicates that many samples failed to meet Quality Control for accuracy and/or precision. Are the values for these samples estimated? Do these samples meet requirements for closure under Class III Soil Table I levels? Provide a statement from the lab if appropriate.

The Cabinet reserves the right to request additional information. The owner/operator will be contacted in writing if more information is requested.

The owner/operator/contractor/consultant bears the responsibility of exploring, identifying, and addressing all potential safety hazards throughout the course of their work.

Two (2) copies of the above-mentioned information must be submitted to the UST Branch by May 14, 2002. Please include the above referenced UST ID# on all documents submitted.

The Office of Petroleum Storage Tank Environmental Assurance Fund (OPSTEAF) auditors and Division of Waste Management (DWM) field inspectors shall be notified ten (10) days in advance, by the owner/operator (contractor/consultant), of the Additional Evaluation sampling events.

The information required by this correspondence represents those actions determined by the OPSTEAF to be "reasonable and necessary" pursuant to 415 KAR 1:080. Cost for investigative or other actions beyond those specifically outlined above may not be eligible for reimbursement. If deviation from the requirements outlined above is necessary and approved by the UST Branch, you should contact the OPSTEAF at (502) 564-5981 or 1-800-928-7782 prior to initiating the work in order to avoid unnecessarily jeopardizing your opportunity for reimbursement.

If you have any questions concerning this matter, please contact Ann Fredenburg at (502) 564-6716 or 1-800-928-4273 extension #605.

Sincerely,

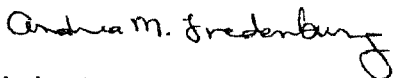

Andrea M. Fredenburg
Environmental Technologist III
Closure Section
Underground Storage Tank Branch
Division of Waste Management

Attachments*

cc: *File /clo/dfqr1
 *Andrea M. Fredenburg (2)
 *OPSTEAF

*ATTN GEORGE MUNICH
C/O MERIT ENVIRONMENTAL INC
P O BOX 436768
LOUISVILLE KY 40253

1" = 40'

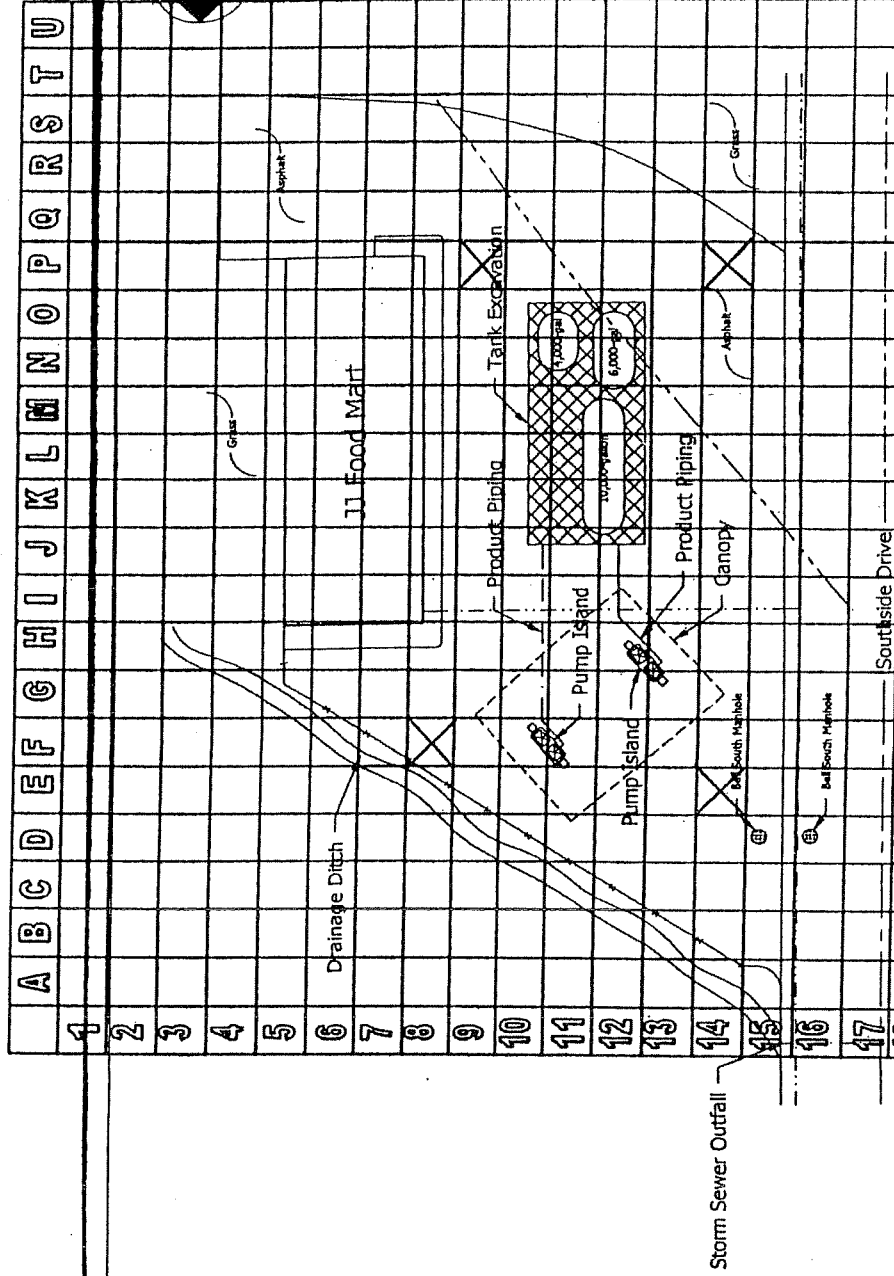

Legend

- = Storm Sewer
- = Water Line
- = Overhead Electric
- = Product Piping
- = Gas Line - Road

Figure 2: Site Diagram

JJ Food Mart
7101 Southside Drive
Louisville, Kentucky

MERT ENVIRONMENTAL, INC.

P.O. Box 436768
Louisville, Kentucky 40253-6768

Kenwood Service Center



836 East Market Street • Louisville, Kentucky 40206
(502) 584-2349 • Fax (502) 584-2353
Toll Free (800) 742-5168

industrial, bulk plant, and service station equipmer

August 29, 2003

ORIGINAL

Kentucky Department of Environmental Protection
Division of Waste Management
Underground Storage Tank Branch
Closure Section
14 Reilly Road
Frankfort, Kentucky 40601-1190

RECEIVED
2003 SEP -2 P 1:55
KY. DIV. OF WASTE MGMT.
U.S.T. BRANCH

Attention: Mr. Daniel Phelps, PG, Geologist III

Subject: *Additional Evaluation Report*
Kenwood BP
6903 Southside Drive
Louisville, Jefferson County, KY 40214
KDEP Facility ID # 4558-056

Dear Mr. Phelps:

On behalf of our client, C. L. McBride Co., Inc./PrinCipaL EnvironMental Group (PEG) is submitting the requested additional evaluation information for the subject facility. This information has been provided in response to your letter dated January 10, 2003. An original and one copy are attached for your review.

If there are any questions regarding this report, please contact Bill Johnston at (502) 895-5009.

Sincerely,

C.L. McBride Co., Inc./PrinCipaL EnvironMental Group

R. William Johnston, P.G.
Division Manager

Attachments

cc: Mr. Vernal Hunt – Site Owner

ADDITIONAL EVALUATION (AE) CHECKLIST

(AE030701) page

UST ID# 4558-056	County Jefferson	Latitude: N38° 11' 28" Longitude: W85° 45' 5"
Facility Name/Address: Kenwood BP 6903 Southside Drive Louisville, KY 40214	Owner's Current Address: Mr. Vernal Hunt 14600 Poplar Lane Louisville, KY 40299	Consultant Name/Address: C. L. McBride Co., Inc. 836 East Market Street Louisville, KY 40206

SITE DATA

Review Regulation	<input type="checkbox"/> Backlog	<input type="checkbox"/> E-Reg	<input checked="" type="checkbox"/> 1996 Regulation
Class	<input checked="" type="checkbox"/> III Soil Table	<input type="checkbox"/> 1	<input type="checkbox"/> 2
Groundwater Table	<input checked="" type="checkbox"/> MCL's	<input type="checkbox"/> Elevated	
If Class IV Matrix Table	<input type="checkbox"/> 1	<input type="checkbox"/> 2	<input type="checkbox"/> 3
Soil type:	Silty Clay	Depth to groundwater	3 feet
If Class IV why?	<input type="checkbox"/> Environmentally Sensitive Features	<input type="checkbox"/> Domestic use well	<input type="checkbox"/> Spring
<input type="checkbox"/> Wellhead Protection Area	<input type="checkbox"/> Fumes	<input type="checkbox"/> Surficial evidence of subsurface release	<input type="checkbox"/> Cistern
Verify current conditions	<input type="checkbox"/> classification guide current	<input type="checkbox"/> revised classification guide submitted	
Historical Tank Contents	<input checked="" type="checkbox"/> gasoline/BTEX	<input checked="" type="checkbox"/> Diesel/PAH	<input type="checkbox"/> Waste Oil/PAH/Lead
		<input type="checkbox"/> Other	

CONTAMINATION SUMMARY

Media Affected	<input checked="" type="checkbox"/> Soil	<input checked="" type="checkbox"/> Groundwater	<input type="checkbox"/> Surface water	<input type="checkbox"/> Drinking water wells	<input type="checkbox"/> Public Water Lines
<input type="checkbox"/> Pit water	<input type="checkbox"/> Other				
Extent of contamination defined	<input type="checkbox"/> yes	<input checked="" type="checkbox"/> no	Explain in "comments section" areas not defined		
Has contamination spread offsite?	<input type="checkbox"/> yes	<input type="checkbox"/> no	<input checked="" type="checkbox"/> unknown	Offsite access problems?	<input type="checkbox"/> yes
					<input checked="" type="checkbox"/> no
Date of SI/AE request:	SI/AE initiated by:		<input checked="" type="checkbox"/> removal	<input checked="" type="checkbox"/> ERT #	ERT Date 4/9/03
				115065	
Free Product Present	<input type="checkbox"/> Yes	<input checked="" type="checkbox"/> No	Are abatement measures implemented?	<input checked="" type="checkbox"/> Yes	<input type="checkbox"/> No
What actions:	<input type="checkbox"/> Hand bailing	<input type="checkbox"/> Vacuum extraction	<input type="checkbox"/> Pumping	<input type="checkbox"/> Skimmer	<input type="checkbox"/> Other
				Absorbent socks	<input type="checkbox"/> None
<input type="checkbox"/> Table summarizing location and thickness of product attached					

ADDITIONAL EVALUATION CONTENT CHECKLIST

(check indicating information is attached)	
<input checked="" type="checkbox"/>	Historical analytical results summarized in a table
<input checked="" type="checkbox"/>	Map with current sampling points and results shown. (One (1) for soil (Not Applicable) and one (1) for groundwater)
<input checked="" type="checkbox"/>	Map indicating potentiometric surface and groundwater flow
<input checked="" type="checkbox"/>	Map with environmentally sensitive features shown, adjoining facilities, locations of pit(s), and borings/mw's
<input checked="" type="checkbox"/>	Geologic cross sections with vertical extent of contamination illustrated
<input checked="" type="checkbox"/>	Topographic map with site location indicated
<input checked="" type="checkbox"/>	Current lab analysis with COC's, surrogate recoveries, etc.
<input checked="" type="checkbox"/>	Survey of all potentially affected buildings and utility lines (Explanation)
<input checked="" type="checkbox"/>	DEP forms for all monitoring wells and assessment wells if not previously submitted
<input checked="" type="checkbox"/>	Complete soil boring logs with total depths, lithologies, soil types, depth to groundwater, and field screening results
<input checked="" type="checkbox"/>	Description of water sample (turbidity, odor, color...etc.) (Explanation)
<input checked="" type="checkbox"/>	All investigation derived wastes properly handled and disposed (Explanation)
<input checked="" type="checkbox"/>	Photos

Tanks currently active?	<input type="checkbox"/> yes	<input checked="" type="checkbox"/> no	If active, date of last tank and line tightness (Tank system removed)
Are there AST's at the facility	<input type="checkbox"/> yes	<input checked="" type="checkbox"/> no	test: Result: <input type="checkbox"/> Pass <input type="checkbox"/> Fail
PE/PG signature:			Date: 8/29/03
Registration #	308		

*Under the requirements of KRS Chapter 322 and 322A, this form shall be completed and signed by a Professional Engineer (P.E.) registered with the Kentucky Board of Registration for Professional Engineers and Land Surveyors, or a Professional Geologist (P.G.) registered with the Kentucky Board of Registration for Professional Geologist.

COMMENTS/CONTRACTOR'S RECOMMENDATIONS

(This information should include any anomalies in data, site specific information which may limit additional evaluation and professional recommendations of the PE/PG.)

A summary of the data collected during this additional evaluation is summarized as follows:

- Benzo(a)anthracene concentrations were detected in 4 of the 9 borings at depths ranging from 5.0 to 10.0 feet that exceed Class III Soil Table 1 allowable levels.
- cPAH concentrations were detected in 3 of the 9 borings at depths ranging from 5.0 to 10.0 feet that exceed Class III Soil Table 1 allowable levels.
- A benzene concentration was detected in one of the three monitoring wells installed that exceeds the Groundwater Table I allowable level.
- No toluene, ethylbenzene, xylene or polynuclear aromatic hydrocarbons were detected in the groundwater samples above Groundwater Table I allowable levels.
- Boring (B-1) may potentially contain free product based on observations made in the field and soil sample results. This boring is interpreted to be in a downgradient direction from the former tank pit.
- The depth to groundwater ranges from approximately 2 to 8 feet bgl.
- Groundwater flow direction is interpreted to be towards the northwest based on water level elevations measured on August 28, 2003.
- No organic vapors were detected in on-site buildings or assessable utilities during this assessment phase.
- Purged groundwater was described as slightly turbid, with a light orange color and no obvious petroleum odor.
- Soil cuttings and purged groundwater have been staged on-site in 55-gallon drums pending proper disposal.

Based on the additional evaluation data, PEG is providing the following recommendations for the site:

- The horizontal extent of the cPAH contamination in soils has not been adequately defined. Additional assessment is needed along the west side and southeast corner of the former tank pit. The vertical extent of soil contamination is defined by the bedrock surface encountered at a depth of approximately 12 feet below ground level (bgl).
- Additional assessment is required to further define the horizontal extent of benzene concentrations in groundwater. In addition, PEG recommends installing an additional monitoring well in the B-1 location to further evaluate if a separate phase product plume potentially exists beneath the subject site.

PE/PG* signature:



Date:

8/29/03

Registration #:

308

* Under the requirements of KRS Chapter 322 and 322A, this form shall be completed and signed by a Professional Engineer (P.E.) registered with the Kentucky Board of Registration for Professional Engineers and Land Surveyors, or a Professional Geologist (P.G.) registered with the Kentucky Board of Registration for Professional Geologists.

Table 1 - Summary of Groundwater Elevations
Kenwood BP
6903 Southside Drive
Louisville, Kentucky
Facility ID # 4558-056

Well Number	Top of Casing Elevation (feet)	Product Level Depth (TOC) (feet)	Water Level Depth (TOC) (feet)	Water Level Elevation (feet)
MW-1	99.86	ND	2.17	97.69
MW-2	100.00	ND	7.99	92.01
MW-3	100.90	ND	4.43	96.47

Notes:

Elevations are established to an on-site benchmark assigned a relative elevation of 100 feet

TOC - Top of casing

MW - monitoring well

Water levels measured on August 28, 2003

Refer to Figure 3 for potentiometric surface map interpretation

ND - Not detected

Table 2 - Summary of Soil Analytical Results
Kenwood BP
6903 Southside Drive
Louisville, Kentucky
Facility ID # 4558-056

Boring Location	B-1	B-2	B-3	B-4	B-5	B-6	B-7	B-8	B-9	TARGET LEVEL (mg/l)
Upper Depth Interval/	3.0'-4.0'	5.0'-6.0'	5.0'-6.0'	7.0'-8.0'	5.0'-6.0'	5.0'-6.0'	7.0'-8.0'	7.0'-8.0'	5.0'-6.0'	
Lower Depth Interval	7.0'-8.0'	9.0'-10.0'	11.0'-12.0'	9.0'-10.0'	9.0'-10.0'	11.0'-12.0'	9.0'-10.0'	9.0'-10.0'	9.0'-10.0'	
PAH CONSTITUENTS										
Naphthalene	2.97/1.63	ND/ND	ND/ND	ND/ND	ND/ND	1.86/ND	ND/2.00	ND/1.08	ND/ND	5
Benzo(a)anthracene	ND/ND	ND/ND	1.95/ND	ND/0.21	ND/ND	ND/ND	0.24/1.43	ND/0.31	0.45/0.49	0.15
Benzo(b)fluoranthene	ND/ND	ND/ND	2.02/ND	ND/ND	ND/ND	ND/ND	ND/1.29	ND/ND	0.46/0.34	0.3
Benzo(k)fluoranthene	ND/ND	ND/ND	1.50/ND	ND/ND	ND/ND	ND/ND	ND/1.03	ND/ND	ND/0.37	0.3
Benzo(a)pyrene	ND/ND	ND/ND	1.61/ND	ND/ND	ND/ND	ND/ND	ND/1.16	ND/ND	0.37/0.34	0.3
Dibenzo(a,h)anthracene	ND/ND	ND/ND	0.52/ND	ND/ND	ND/ND	ND/ND	ND/0.95	ND/ND	ND/ND	0.3
indeno(1,2,3-c,d)pyrene	ND/ND	ND/ND	1.52/ND	ND/ND	ND/ND	ND/ND	ND/ND	ND/ND	0.38/ND	0.3

Notes:

mg/kg - milligrams per kilogram (parts per million)

Refer to laboratory data sheets for individual constituent concentrations in tabular form

Concentrations in **BOLD** are in excess of Class III, Soil Table I allowable concentrations (Target Level)

ND - Not detected above laboratory detection limits

Samples collected on August 12-13, 2003 for analysis

PAH - polynuclear aromatic hydrocarbons by EPA Method 8270

Table 3 - Summary of Groundwater Analytical Results
Kenwood BP
6903 Southside Drive
Louisville, Kentucky
Facility ID # 4558-056

Constituent	MW-1	MW-2	MW-3	TARGET LEVEL (mg/l)
BTEX CONSTITUENTS				
Benzene	<0.005	<0.005	0.068	0.005
Toluene	<0.005	<0.005	<0.005	1
Ethylbenzene	<0.005	<0.005	0.122	0.7
Xylenes	<0.005	<0.005	0.170	10
PAH	ND	ND	ND	-

Notes:

mg/l - milligrams per liter (parts per million)

Refer to laboratory data sheets for individual constituent concentrations in tabular form

Concentrations in **BOLD** are in excess of Groundwater Table I allowable concentrations (Target Level)

ND - Not detected above laboratory detection limits

Samples collected on August 21, 2003 for analysis

BTEX - benzene, toluene, ethylbenzene and xylenes by EPA Method 8260

PAH - polynuclear aromatic hydrocarbons by EPA Method 8270

B-9
5.0'-6.0'
PAHs
BENZO(a)ANTHRACENE - 0.45
BENZO(b)FLUORANTHENE - 0.46
BENZO(a)PYRENE - 0.37
INDENO(1,2,3-c,d)PYRENE - 0.38
9.0' - 10.0'
PAHs
BENZO(a)ANTHRACENE - 0.49
BENZO(b)FLUORANTHENE - 0.34
BENZO(k)FLUORANTHENE - 0.37
BENZO(a)PYRENE - 0.34

B-8
7.0'-8.0'
PAHs - ND
9.0' - 10.0'
PAHs
NAPHTHALENE - 1.08
BENZO(a) ANTHRACENE - 0.31

B-7
7.0'-8.0'
PAHs
BENZO(a) ANTHRACENE - 0.24
9.0'-10.0'
PAHs
NAPHTHALENE - 2.00
BENZO(a)ANTHRACENE - 1.43
BENZO(b)FLUORANTHENE - 1.29
BENZO(k)FLUORANTHENE - 1.03
BENZO(a)PYRENE - 1.16
DIBENZO(a,h)ANTHRACENE - 0.95

B-1
3.0'-4.0'
PAHs
NAPHTHALENE - 2.97
7.0' - 8.0'
PAHs
NAPHTHALENE - 1.63

B-2
5.0'-6.0'
PAHs - ND
9.0' - 10.0'
PAHs - ND

COMMERCIAL PROPERTY

ROBERTS AVENUE

FORMER
UST PIT AREA

B-3
5.0'-6.0'
PAHs
BENZO(a)ANTHRACENE - 1.95
BENZO(b)FLUORANTHENE - 2.02
BENZO(k)FLUORANTHENE - 1.50
BENZO(a)PYRENE - 1.61
DIBENZO(a,h)ANTHRACENE - 0.52
INDENO(1,2,3-c,d)PYRENE - 1.52
11.0' - 12.0'
PAHs - ND

B-6
5.0'-6.0'
PAHs
NAPHTHALENE - 1.86
11.0' - 12.0'
PAHs - ND

MAINTENANCE GARAGE
(KENWOOD BP)

B-4
7.0'-8.0'
PAHs - ND
9.0' - 10.0'
PAHs
BENZO(a) ANTHRACENE - 0.21

B-5
5.0'-6.0'
PAHs - ND
9.0' - 10.0'
PAHs - ND

GARAGE

COMMERCIAL PROPERTY

SOUTHSIDE DRIVE

URAL GAS
SANTARY SEWER
TELEPHONE
NATURAL GAS

PAHs - POLYNUCLEAR AROMATIC HYDROCARBONS
ND - NOT DETECTED ABOVE LABORATORY DETECTION LIMITS
mg/kg - MILLIGRAMS PER KILOGRAM
NOTE: SAMPLES COLLECTED ON AUGUST 12-13, 2003

LEGEND

- SOIL BORING
- ⊕ MONITORING WELL (NO SOIL SAMPLES COLLECTED FROM WELL BORINGS)

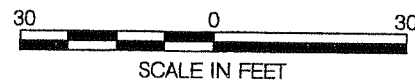

DATE: 8/25/03
SCALE:
DRAWN BY: CCD
CHECKED BY:
DRAWING ID: 4558056-4
FACILITY ID: 4558-056

PrinCipal EnvironMental Group, Inc.
a division of C.L.McBride Co.

Figure
1

SITE PLAN SHOWING
SOIL SAMPLE ANALYTICAL RESULTS

KENWOOD BP
6903 SOUTHSIDE DRIVE
LOUISVILLE, KENTUCKY

COMMERCIAL PROPERTY
SOUTHSIDE DRIVE

URAL GAS
SANTARY SEWER
TELEPHONE
NATURAL GAS

MW-2
B - <0.005
T - <0.005
E - <0.005
X - <0.005
PAHs - ND

MW-2
GRASS ISLAND

COMMERCIAL PROPERTY

ROBERTS AVENUE

B-2
B-1
B-9
B-8
B-7
B-6
FORMER
UST PIT AREA

CANOPY

OFFICE

MAINTENANCE GARAGE
(KENWOOD BP)

GARAGE

MW-3
B - 0.068
T - <0.005
E - 0.122
X - 0.170
PAHs - ND

MW-1
B - <0.005
T - <0.005
E - <0.005
X - <0.005
PAHs - ND

BTEX - BENZENE, TOLUENE, ETHYLBENZENE, XYLENES
PAHs - POLYNUCLEAR AROMATIC HYDROCARBONS
ND - NOT DETECTED ABOVE LABORATORY DETECTION LIMITS
mg/l - MILLIGRAMS PER LITER

NOTE: SAMPLES COLLECTED ON AUGUST 21, 2003

LEGEND

- SOIL BORING
- ⊕ MONITORING WELL

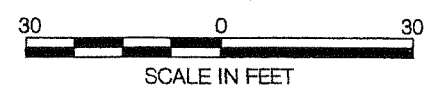

DATE: 8/25/03
SCALE:
DRAWN BY: CCD
CHECKED BY:
DRAWING ID: 4558056-4
FACILITY ID: 4558-056

PrinCipal EnvironMental Group, Inc.
a division of C.L.McBride Co.

Figure
2

SITE PLAN SHOWING
GROUNDWATER SAMPLE
ANALYTICAL RESULTS

KENWOOD BP
6903 SOUTHSIDE DRIVE
LOUISVILLE, KENTUCKY

COMMERCIAL PROPERTY

SOUTHSIDE DRIVE

URAL GAS
SANTARY SEWER
TELEPHONE
NATURAL GAS

(92.01)
MW-2
GRASS ISLAND

COMMERCIAL
PROPERTY

ROBERTS AVENUE

FORMER
UST PIT AREA

OFFICE

MAINTENANCE GARAGE
(KENWOOD BP)

GARAGE

LEGEND

● SOIL BORING

⊕ MONITORING WELL

— EQUIPOTENTIAL LINES

(97.69) RELATIVE WATER LEVEL ELEVATION IN FEET

← INTERPRETED GROUNDWATER FLOW DIRECTION

NOTE: ELEVATIONS MEASURED TO AN ON-SITE
BENCHMARK ASSIGNED A RELATIVE ELEVATION
OF 100 FEET.

30 0 30
SCALE IN FEET

DATE: 8/28/03

SCALE:

DRAWN BY: CCD

CHECKED BY:

DRAWING ID: 4558056-4

FACILITY ID: 4558-056

PrinCipaL EnvironMental Group, Inc.
a division of C.L.McBride Co.

Figure
3

GROUNDWATER
POTENTIOMETRIC
SURFACE MAP - 8/28/03

KENWOOD BP
6903 SOUTHSIDE DRIVE
LOUISVILLE, KENTUCKY

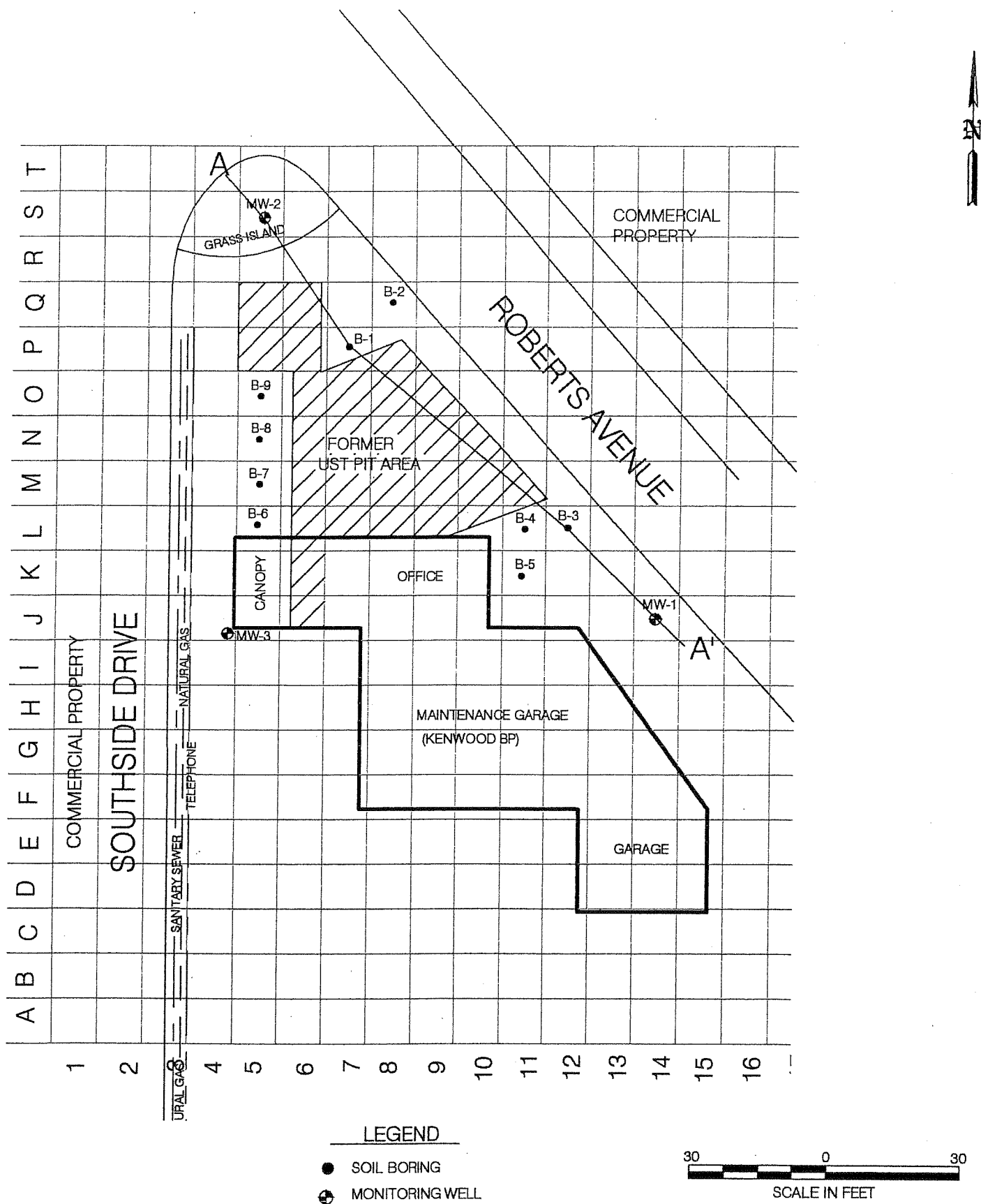

DATE: 8/25/03
 SCALE:
 DRAWN BY: CCD
 CHECKED BY:
 DRAWING ID: 4558056-4
 FACILITY ID: 4558-056

PrinCipAL EnvironMental Group, Inc.
 a division of C.L.McBride Co.

SITE PLAN SHOWING
 SURROUNDING PROPERTIES

Figure
 4

KENWOOD BP
 6903 SOUTHSIDE DRIVE
 LOUISVILLE, KENTUCKY

HORIZONTAL SCALE 1"=30'

VERTICAL SCALE 1"=5'

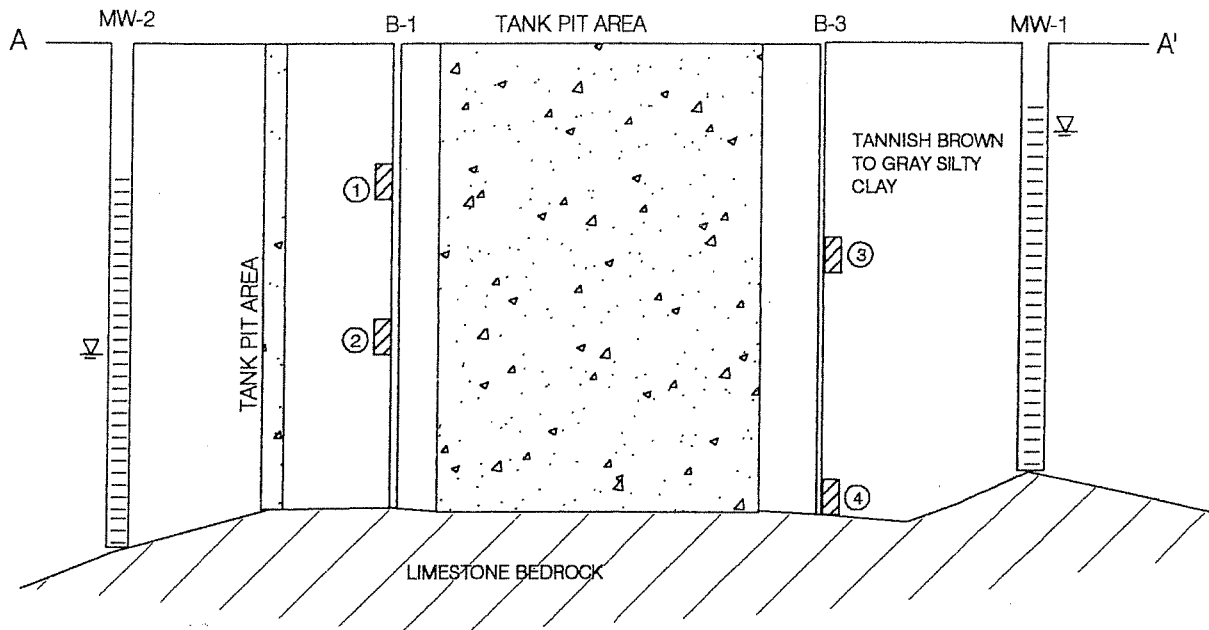

SOIL BORING RESULTS

- B-1
3.0'-4.0'
PAHs
① NAPHTHALENE - 2.97
- 7.0' - 8.0'
PAHs
② NAPHTHALENE - 1.63
- B-3
5.0'-6.0'
PAHs
BENZO(a)ANTHRACENE - 1.95
BENZO(b)FLUORANTHENE - 2.02
BENZO(k)FLUORANTHENE - 1.50
BENZO(a)PYRENE - 1.61
DIBENZO(a,h)ANTHRACENE - 0.52
INDENO(1,2,3-c,d)PYRENE - 1.52
- 11.0' - 12.0'
PAHs - ND
④

▽ WATER LEVEL MEASURED 8/28/03

DATE: 8/28/03
SCALE:
DRAWN BY: CCD
CHECKED BY:
DRAWING ID: 4558056-4
FACILITY ID: 4558-056

PrinCipal EnvironMental Group, Inc.
a division of C.L.McBride Co.

Figure
5

CROSS SECTION

KENWOOD BP
6903 SOUTHSIDE DRIVE
LOUISVILLE, KENTUCKY

Valvoline Instant Oil

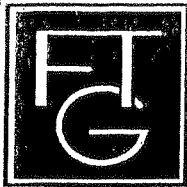

FOPPE TECHNICAL GROUP, INC.
Civil, Environmental and
Geotechnical Consultants

RECEIVED

JUL 23 11 52 AM '98

July 20, 1998

D.W.M.
SUPERFUND BRANCH

WM
HAZARDOUS
WASTE

Mr. John Michels
Superfund Branch
Division of Waste Management
Kentucky Department of Environmental Protection
Frankfort Office Park
14 Reilly Road
Frankfort, Kentucky 40601

RE: Request for No Further Action Status

RR #A9529

Valvoline Instant Oil Change

7401 Third Street

Louisville, Kentucky

Jefferson County

COUNTY:

Jefferson

FACILITY:

Valvoline Instant Oil Change

I. D. #:

A9529

SECTION:

Superfund

Dear Mr. Michels:

Per the conditions of the Corrective Action Plan (CAP) acceptance letter for the above referenced facility, the Valvoline Company is submitting this Request for No Further Action Status.

The installation of two monitor wells (MW1 and MW2) was completed by Foppe Technical Group, Inc. (FTG) on February 21, 1997. These two wells were installed in the basement floor of the Valvoline Instant Oil Change building in the locations shown on the Groundwater Analysis Diagram presented as Figure 1.

Baseline sampling of the monitoring wells was performed by FTG on February 21, 1997. Monitor wells were re-sampled on March 5, 1997 and June 25, 1997. In October, 1997, the decision was made to forgo the sampling of the two wells previously installed in the basement floor (MW1 and MW2) and to install an additional well through the floor of the facility bay area. While on-site to install this well, it became apparent that the well would have to be placed just outside the building due to restrictions posed by the height of the bay and the subgrade material. The location of the new monitor well installed on December 16, 1997, labeled MW3, is also shown on Figure 1.

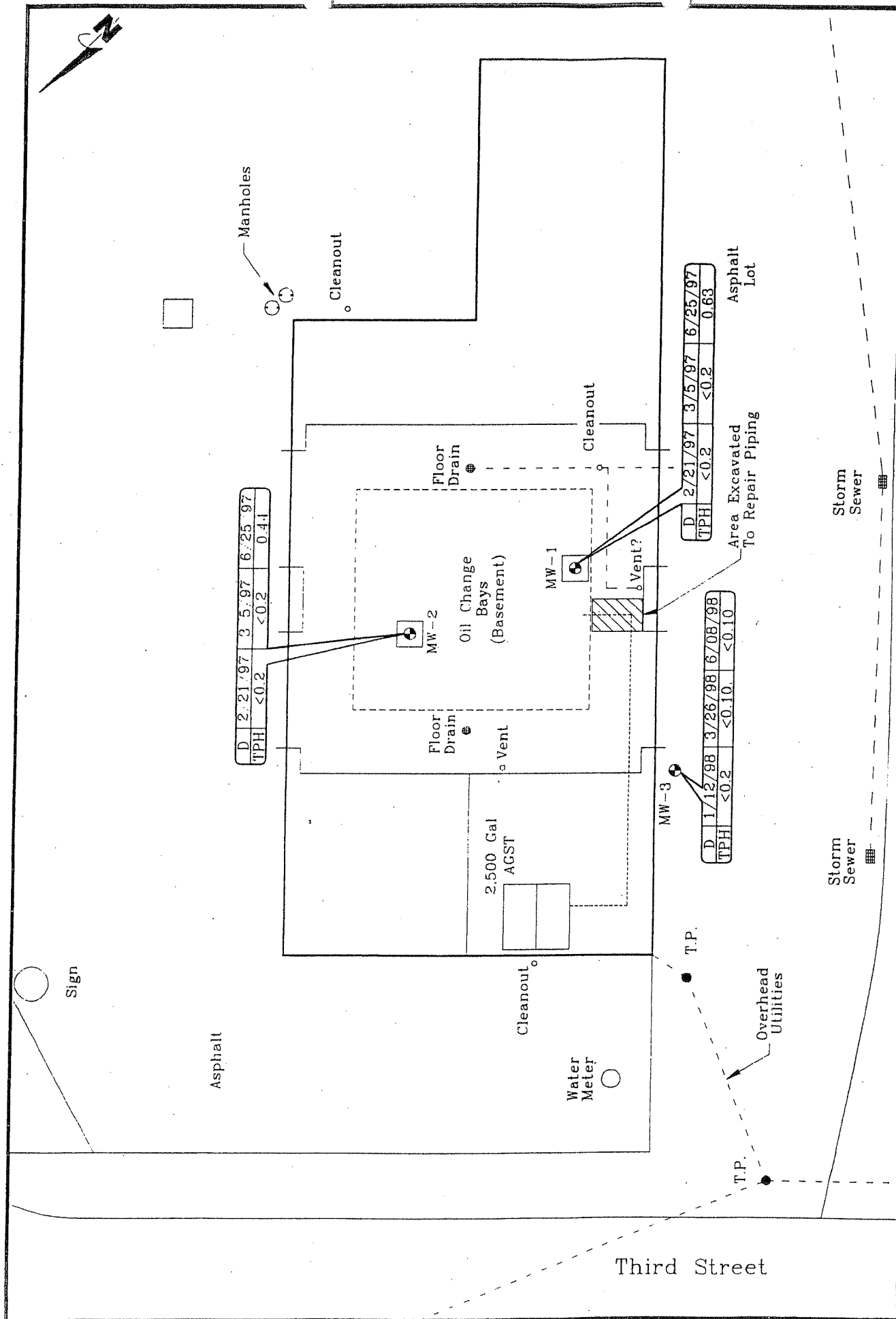

LEGEND

- Monitor Well Locations
- D - Date Sampled
- TPH - Total Petroleum Hydrocarbons (Method 8015) Diesel Range Organics (mg/l)

Project #: 96057S-15

Ref. #: 96057SP

Drawn By: TJB

Date: 7/20/98

Project Mgr.: DWA

FIGURE 1:

GROUNDWATER ANALYSIS DIAGRAM

VALVULINE INSTANT OIL CHANGE

7401 THIRD STREET

LOUISVILLE, KENTUCKY

July 20, 1998

The wells previously installed in the basement (pit area) are no longer being used to monitor this facility. Therefore, the Unusual Discharge Request (UDR) for the discharge of the wells to be directed to the on-site oil-water separator is no longer necessary for quarterly monitoring. Groundwater analytical results for the sampling events conducted to date are shown on Figure 1 and Table 1. Laboratory analytical results and chain-of-custody forms for the latest sampling event on June 8, 1998 are included in Attachment 1.

Table 1: Groundwater Sampling Results		
Sampling Location	Date Sampled	TPH 8015 DRO (diesel range organics)
MW1	2/21/97	<0.2 mg/L
	3/5/97	<0.2 mg/L
	6/25/97	0.63 mg/L
MW2	2/21/97	<0.2 mg/L
	3/5/97	<0.2 mg/L
	6/25/97	0.44 mg/L
MW3	1/12/98	<0.2 mg/L
	3/26/98	<0.1 mg/L
	6/8/98	<0.1 mg/L
Laboratory Detection Limit		0.2 mg/L / 0.1mg/L

Both the baseline and 1st quarterly monitoring results were found to be below the laboratory detection limit of 0.2 mg/l. The laboratory results for the June 25, 1997 sampling event indicate slightly elevated concentrations of TPH (0.63 mg/l for MW1 and 0.044 mg/l for MW2). The results of the sampling and analysis on June 8, 1998, indicated no detectable concentration of TPH at the new well, MW3, for the third consecutive quarter. In February 1998 Custom Analytical Services, Inc. changed the lower level standard that is employed in the TPH 8015 DRO analysis from a concentration of 0.105 to a concentration of 0.083 which accounts for the change in the reported Laboratory Detection Limit.

In accordance with the CAP, FTG, on behalf of The Valvoline Company, respectfully requests that No Further Action Status be granted to this site. If you should have any questions or concerns regarding this project, please feel free to contact me (513) 671-8144.

Respectfully submitted,

FOPPE TECHNICAL GROUP, INC.



Kendall S. Harsch

Geologist

Reviewed By:

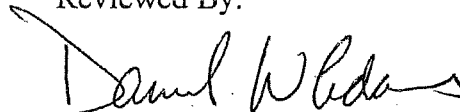

Daniel W. Adams, P.G.

Senior Geologist

cc: Mr. Jason Jacobs, The Valvoline Company

FTG file: 96057S-15

f:/rpts/dft/96057nfa

ATTACHMENT 1

**CHAIN-OF-CUSTODY/
LABORATORY ANALYTICAL REPORTS**



CUSTOM ANALYTICAL SERVICES
Responsive To Our Client's Needs

11405 Century Blvd. • Cincinnati, Ohio 45246
(513) 671-5030 • FAX (513) 671-5240

1998060015

CHAIN OF CUSTODY RECORD

CAS 007080

Page 1 of 1

Project No.		Project Name:		Location Of Sampling Site:		ANALYSIS AND METHOD REQUESTED										Shipment Seal No.					
960575-15-051R		VIOC		LOUISVILLE, KY																	
SAMPLER (Signature)		Purchase Order NO.																			
<i>Julie</i>																					
NO.	SAMPLE FIELD I.D. NUMBER	DATE	TIME	COMP	GRAB	MATRIX	NO. OF CONT.	TYPE CONTAINER	PRES-ERV.	ANAL											
1	MW 3	6.8.98			X	Water	2	Amber pr	-	VOC	SVOC	BTEX	PAH	TPH	8015	TOTAL LEAD	PCPA METALS	CAS ID. NO. Filled In By Lab			
2																		060015-1			
3																					
4																					
5																					
6																					
7																					
8																					
9																					
10																					
11																					
12																					

REMARKS / SPECIAL INSTRUCTIONS: (LIMIT OF DETECTION, RUSH RESULTS REQUESTED, ETC.)

1. Relinquished by: (Signature)	Date / Time	1. Received by: (Signature)	Date / Time	2. Relinquished by: (Signature)	Date / Time	2. Received by: (Signature)
<i>Samuel</i>	6.8.98 4:20 p.m.					
3. Relinquished by: (Signature)	Date / Time	3. Received by: (Signature)	Date / Time	4. Relinquished by: (Signature)	Date / Time	4. Received by: (Signature)
5. Relinquished by: (Signature)	Date / Time	Received for Laboratory by: (Sig.)	Date / Time	Client ID Number:		
		<i>Steve P. [Signature]</i>	6/8/98 4:20			

SEAL INTACT AT LAB? YES NO

Report Results To: *DWA* Phone No.:

Client : FTG
Project Number : 960575-15
Chain-of Custody No.: 7080

**Quality Assurance / Quality Control
Project Review**

Quality Indicators	Status		Comment Footnote
	Acceptable	Out of Range	
Organics			
Initial Calibration	[<input checked="" type="checkbox"/>]	[]	
Continuing Checks	[<input checked="" type="checkbox"/>]	[]	
Laboratory Control Standard	[<input checked="" type="checkbox"/>]	[]	
Surrogates	[<input checked="" type="checkbox"/>]	[]	
MS / MSD	[<input checked="" type="checkbox"/>]	[]	
Inorganics and Metals			
Blank	[]	[]	
Initial Calibration	[]	[]	
Continuing Checks	[]	[]	
Laboratory Control Standard	[]	[]	
Spike	[]	[]	
Duplicate	[]	[]	

BTEX Surrogate (a,a,a-trifluorotoluene) acceptable recovery range: 45-156 %

PAH Surrogate (2-fluorobiphenyl) acceptable recovery range: water: 43-116 %
soil: 30-115 %

All "Out of Range" Indicators must have an explanatory comment.
Comment footnote refers to the table above.

Comments:

Prepared By: J. Enigues Date: 6/12/98

Laboratory Analytical Report

Project Number: 960575-15-051R
Project Name: VIOC
C.O.C. Number: 7080
Sample Location: Louisville, KY

Date Sampled: 06/08/1998
Date Received: 06/08/1998
Sample Matrix: Water
Date Extracted:

C.A.S. Order Number: 1998060015 Field ID: MW 3 Sample Number: 1

COMPOUND	CONCENTRATION	DATE OF ANALYSIS
Organic Chemistry TPH (SW 8015 Mod Diesel)	< 0.10 mg/L	06/10/1998

JEFFERSON COUNTY, KENTUCKY
DIVISION OF ENVIRONMENTAL HEALTH AND PROTECTION

COMPLAINT NO. 308363 R/A 688

DUPLICATE NOS. _____ R/A _____
_____ R/A _____
_____ R/A _____
_____ R/A _____

PULL DATES:

Recall	DRS	
3-28-97		
3-29-97		

ASSIGNMENTS:

1966 - 13		

EXCEPTION CODES

S SAMPLES (S#) - ATTENDANCE (S#)
X INSPECTION TO COMPLAINT
Y COMPLAINT TO COMPLAINT
DRS FILE COMPLAINT (RESOLVED)

TYPE OF CODES

01 INSPECTION	05 DOCUMENTED VISIT	09 SURVEY/CLINIC (S#)
02 FOLLOW-UP	06 EMERGENCY RESPONSE	10 EDUCATION
03 COMPLAINT	07 OTHER FIELD ACTIVITY	11 SAMPLES (S#)
04 SURVEY (EVALUATION)	08 OFFICE/PHONE	

ACTION CODES

A NO ACTION INDICATED	U RECALL	CC RAZE/REPAIR ORDER
B INVALID COMPLAINT	V POSITIVE	CD REFER-WORKS DEPT.
C ABATED/CORRECTED	W NEGATIVE	CE SERVICED BY-PUBLICATION
D REFERRAL	X SAMPLE REJECTED	CF CASE PASSED TO ANOTHER DATE
E NOTICE TO CORRECT	Y INSPECTION FAILURE	CG CASE REINSTATED-MOTION TO REVOKE
F NOTICE TO SUSPEND	Z CEASE OPERATION	CH FAILURE TO APPEAR-BENCH WARRANT
G PERMIT SUSPENDED	#A NO RESPONSE	CI NOT SERVICED-CRIMINAL SUMMONS ISSUED
H PERMIT RE-INSTATED	#B ADVISED	CJ FIRST CALL-ARRAIGNMENT
I PERMIT REVOKED	#C BAITED/TREATED	CK DISMISSAL W/O PREJUDICE-COMPLIANCE
J NOTICE -APPLY/CEASE	#D HEARING NOTICE	CL DISMISSAL W/O PREJUDICE-NON-COMPLIANCE
K HEARING HELD	#E PRECOURT INSPECTION	CM PLEA GUILTY-FINE ASSESSED
L COURT ACTION BEGUN	#F COURT APPEARANCE	CN PLEA GUILTY-FINE SUSPENDED
M COURT JUDGMENT	#G SITE EVALUATION FAILURE	CO TRIAL-GUILTY-FINE ASSESSED
N INJUNCTION	#H SUSPENSION -FOOD	CP TRIAL-GUILTY-FINE SUSPENDED
O VOLUNTARY ACTION INDICATED	#I SUSPENSION-RETAIL	CQ TRIAL-DISMISSED-INSUFFICIENT PROOF
P OFFICIAL ACTION INDICATED	#J SITE UNAPPROVABLE	CR TRIAL-NOT GUILTY
Q QUARANTINE	#K AFFIDAVIT	CS OTHER
R RELEASED	#L VARIANCE ISSUED	
S SITE EVALUATION APPROVED	CA HOUSING COURT	
T DYE TESTING	CB BOARD /SECURE ORDER	

see
Hmpe
file

Complaint No: 308363
Address Of Problem Site: 7401 Bell 3rd St Rd.

CENSUS
TRACT#
.00

CMPLNT/SERVICE ADDR : 7401 OLD THIRD STREET RD
CITY/ST/ZIP LOUISVILLE KY 40214

PERSON OR PREMISES TO SEE: PAINT THINNER AND OIL VALVOLINE

ADDR1
CITY/ST/ZIP
(FM FHN)

(CWRK PHN)

ADDR1
CITY/ST/ZIP
PHONE #

BITE?	ESTAB#	ORIGINAL	NXT INSP	RESOLVED	SANIT	TYPE	COURT	EPI
N					01966	C	N	

TYPE	SANIT	DATE	ACT	(NEXT INSPECTION DATE)	F	EXCEPTIONS
06	1966	11/11/96	E	Return		
02	1966	2/28/97	B	3-28-97		
02	1966	5/1/97	C	ORS		

ENVIRONMENTAL HEALTH
and PROTECTION
Emergency Action Team,
Notification and Response Record

INCIDENT REPORT# EDF.96

DATE 11, 11, 96

EVENT TIME: 130 HRS.

NOTIFICATION VIA: Pager REQUESTING AGENCY or FIRE DISTRICT FAIRDALE

INCIDENT LEVEL- not declared 1 2 3 DECLARED: _____ hrs. RESPONSE CODE 1 2 3

NOTIFICATION - _____ (group 2) 141 (group 3) _____ (group 4) Hrs.

ARRIVAL ON SCENE- 235 DEPARTED FROM SCENE- 435 hrs.

INCIDENT ADDRESS: 7401 old Third Street Road

INCIDENT TYPE- [Fixed facility] Transportation Other 40214

RESPONSIBLE PARTY: VALVOLINE INSTANT OIL CHANGE INC

ADDRESS: 7401 old Third Street Road CITY/STATE COV Ky. 40214

CONTACT PERSON: Joe Alden TITLE: DRIVER mgr PHONE- (502) 361258

MATERIAL(s) INVOLVED: PAINT THINNER And oil Residue

AMOUNT(s): 15 Gallons and unknown

CAUSE: Worker error _____ Equipment failure _____ Improper disposal X AND REOCCURRING PROBLEM

COMMENT THE MANAGER OF VALVOLINE CALLED THE POLICE AFTER EMPLOYEES FOUND (3) THREE-(5) FIVE GALLONS CONTAINING OF AN UNKNOWN SUBSTANCE THAT HAD BEEN PLACED BY THEIR DUMPSTER. THE POLICE REFERRED THE MATTER TO

AGENCIES INVOLVED: LPD LFD LEMS LJCD ELS JCPD JCEMS JCWks (MSD) Fire dept.

FAIRDALE FPD _____ FPD _____ FPD _____ FPD KYDES KYFM KYNREPC KY HWY KYDOT

USCG USEPA/TAT OTHER _____

INJURIES _____ DECONTAMINATIONS _____ : Comments _____

PROTECTIVE ACTIONS: NONE

REFERENCE SOURCES: TOMES (HAZARD _____ HSDB _____) CHEMTOX _____

DOT _____ CHRIS _____ GFSCPC _____ NIOSH _____ OTHER _____

ENVIRONMENTAL SAMPLING AND REVIEW COMMENTS: - I OBSERVED oil
Residue coming From dumpster AREA.

SARA TITLE III \ OSHA COMMENTS: NONE

CONTROL ACTIONS TAKEN: Facility manager called for VACUUM
Truck to pump out Catch Basin - Employees will
spread ABSORBENT on oil Residue to clean it up ^{BOOM} _{PLACED}
_{in BAS}

HEALTH DEPT STAFF INVOLVED: D. Reed FROM 215 TO 435 hrs. 2.50

FROM _____ TO _____ hrs.

FROM _____ TO _____ hrs.

FROM _____ TO _____ hrs.

HEALTH STAFF EXPOSURE: None \ Inhalation Skin Ingestion _____

EXPOSURE COMMENTS _____

LEVEL(s) of PPE USED BY STAFF BUNKER GEAR

PPE / EQUIPMENT DISPOSED OF AS RESULT OF INCIDENT

CELLULAR PHONE usage: 2 min.

ORDER ISSUED Yes \ No

REFERAL Yes \ No

FOLLOW UP NEEDED YES \ NO



JEFFERSON COUNTY, KENTUCKY
DIVISION OF ENVIRONMENTAL HEALTH AND PROTECTION

Terr. _____

Time 3:20 P.M.

11-11, 19 96

ORDER for the correction
of conditions at _____

1401 Old Third Street Road
(Address) DOVER, IN

Valentine Instant Oil Change Inc. Nott Owner ✓
(Name) Agent ✓
Tenant ✓

7501 Old Third Street Road Louisville, Ky. 40217
(Address)

You are hereby notified to REMOVE ALL OIL RESIDUE
FROM CATCH BASIN AND AROUND BASIN.
CONTAIN ALL OIL RESIDUE COMING YOUR LOT.
DISPOSE OF ALL CONTAMINANTS PROPERLY
ACCORDING TO FEDERAL, STATE AND LOCAL
REGULATIONS. COPIES OF DISPOSAL
RECORDS SHOULD BE KEPT ON FILE.

The Health Department expects you to comply with this order by 11-11-96

If necessary, court proceedings may be initiated for the enforcement thereof.

By order of the Director of Health

David A. Head
Representative

HEARING NOTICE

RE: order issued

An opportunity for an administrative hearing will be provided to you if requested, either in writing or by telephone (502) 574-6650 to the Louisville and Jefferson County Health Department on or before 11-15-96.

If you so elect you may be represented by an attorney or other representative.

SAN. #14 (rev. 11/94)

A Partnership of the Department of Health and the Department of Planning & Environmental Management

400 East Gray Street ♦ P.O. Box 1704 ♦ Louisville, Kentucky 40201-1704 ♦ (502) 574-6650 ♦ FAX (502) 574-5734

Printed on Recycled Paper

RE: INITIAL INSPECTION

ADDRESS OF PROBLEM SITE: 7401 Old Third Street Rd.

DATE OF INITIAL INSPECTION: 2/23/97 ARRIVAL: 240 DEPARTURE: 300

CONDITIONS FOUND: Rechecked site - Barrels HAVE BEEN removed - I spoke with maintenance man who advised they have been keeping absorbent down and are going to put a curb in to retain any runoff. He said he would call me with the game plan next week.

5-1-97 330 File PDS - site is clear and staying that way.

D Reed
REPRESENTATIVE

12/02/96

EVENT DESCRIPTION FILE
EVENT REPORT

Page: 1

Event ID: KYLJ-96-121 Date of Entry: 11/26/96 Surveillance? No
Event Information

Event Date: Monday, 11/11/96 Event Time:
Cause: Improper Disposal

Event Location

Address: ~~7401 Old Third Street Road~~
Fairdale, KY 40214
County: Jefferson
Area Type: Commercial

DRAFT

Source of Event

Transportation:
Fixed Facility: Storage above ground

Event Summary

=====

Employees of Valvoline Instant Oil Change observed three thirty-five gallon drums beside their dumpster when they opened for business. They called the Jefferson County Police Department who in turn called the Fairdale Fire Department. The fire department arrived on scene and declared a Level One Haz Mat due to the fact that they observed some oil residue in a drainage vault next to the dumpster. The oil residue appeared to be coming from run off around the dumpster area. Environmental Health and Protection and MSD responded to the scene. Both agencies have been on the site previously and have been working with the facility owners on problems at the site. We advised the facility manager that he was responsible for the drums left at his site unless the responsible party can be found. We issued an order for the cleanup of the oil residue in the drainage vault to ensure the oil would not migrate to the nearby drainage area. We will continue to monitor the facility for compliance.

Notification Contact

Notif. Date: 11/11/96 Notif. Time: 13:57
Type: OSC/Incident commander or staff
Level: Local
Name: Fairdale Fire Department
Address: Mitchell Hill Road
Louisville, KY
County: Jefferson
Phone: - - Ext:
Fax:

12/02/96

EVENT DESCRIPTION FILE
EVENT REPORT

Page: 2

Event ID: KYLJ-96-121 (continued)

First Notification of Health Department

City/County: 11/11/96 State: Federal:
13:57

Substance Information

Substance: Chemical

Name: WASTE OIL

CAS#: DOT#: 1993 UN#: CHRIS#:

Type of Release: Spill

Quantity Released: Unknown

Comment

Oil residue leaked from a dumpster and entered a catch basin.

Reference Contact

Name: Valvoline Instant Oil Change
Address: 7401 Old Third Street Road
Joe Alden, District Manager
Louisville, KY 40214
County: Jefferson
Phone: 502-361-2583 Ext:
Fax:

Responder Information

Arrival Date: 11/11/96 Time: 14:35
Departure Date: 11/11/96 Time: 16:35

Response Plan Followed: Title III
Resource List (none)

Emergency Action Termination Date: 11/11/96 Time: 16:35
Abated Date:
Follow-up Required? Yes

Injuries/Decontamination

Injury Totals

Died	0
Admitted to hospital	0
Treated at medical facility	0
Treated on scene	0
Total injured	0

Injury Summaries(none)

12/02/96

EVENT DESCRIPTION FILE
EVENT REPORT

Page: 3

Event ID: KYLJ-96-121 (continued)

Decontamination Services	Employees	Responders	Others	Total
Decontaminated at medical facility	---	---	---	0
Decontaminated on scene	---	---	---	0
Total decontaminated				0

Evacuation/In-Place Sheltering

Number of Individuals Living Within			
1/4 Mile:	0	1/2 Mile:	0
		1 Mile:	0

Number of Individuals at Home Within			
1/4 Mile:	0	1/2 Mile:	0
		1 Mile:	0

Number of Individuals Working Within			
1/4 Mile:	0	1/2 Mile:	0
		1 Mile:	0

Did people leave their home or work as a result of the event? No

Number of commuters who drove past or through the affected area: 0

Did an official order an evacuation? No

Area of evacuation:

Number of times an evacuation was ordered: 0

Total number of people evacuated from home, school, work, etc.: 0

Length of evacuation: 0 days 0 hours

Did an official order in-place sheltering? No

Did an official provide precaution instructions for the sheltering? No

Agencies Involved

=====

Fairdale Fire Department, Environmental Health Department, MSD

Control Actions Taken

=====

The facility will be responsible for proper disposal of the contents of the three drums. The manager called in their waste oil hauler to vacuum out the drainage vault.

Health Actions Taken

=====

We issued an order for cleanup of the oil residue from the drainage vault and advised the facility manager on proper

12/02/96

EVENT DESCRIPTION FILE
EVENT REPORT

Page: 4

Event ID: KYLJ-96-121 (continued)
disposal of the three drums.

Future Action Reference

=====

We will recheck site to ensure proper cleanup has been done.

Site-Specific Data

Abated date:

Incident Report # 96121.00

Census Tract:

Response code (1\3) 1.00

RESPONSIBLE PARTY: Valvoline Instant Oil Change Incorporated

Address: 7401 Old Third Street Road

Phone: 502-361-2583

Contact person: Joe Alden, District Manager

Cause of release: Improper Disposal

HD Staff Involved: D.Reed

Personnel Exposure: None

P.P.E. Used: Bunker Gear

Reference Sources: None

---End of Report---

BP Oil



ERNIE FLETCHER
GOVERNOR

ENVIRONMENTAL AND PUBLIC PROTECTION CABINET

DEPARTMENT FOR ENVIRONMENTAL PROTECTION
DIVISION OF WASTE MANAGEMENT
LOUISVILLE REGIONAL OFFICE
9116 LEESGATE ROAD
LOUISVILLE, KENTUCKY 40222
www.kentucky.gov

LAJUANA S. WILCHER
SECRETARY

August 4, 2004

KP Oil, Inc.
3801 Tupelo Drive
Columbus, IN 47202
Attn: Ms. Pam Barker

Re: Technical Compliance Inspection

Dear Ms. Barker:

The attached report has been sent to you concerning your facility (9030-056). The report was generated as the result of a routine technical compliance inspection conducted on July 19, 2004. During the inspection I did not observe any violations.

If you have any questions regarding this matter, I can be reached at (502) 425-4543.

Sincerely,

A handwritten signature in black ink, appearing to read "Jeffrey P. Salmon".

Jeffrey P Salmon
Environmental Inspector III

JS/jsa

Environmental and Public Protection Cabinet
Department for Environmental Protection
Division of Waste Management
Technical Compliance Inspection

Site/Permit ID: 9030056			Regional Office: LOUISVILLE		
Site Name: TOBACCO ROAD BP #21			NotCom #:		AI #:
Site Address: 5469 NEW CUT RD					
City: LOUISVILLE		State: Kentucky		Zip: 40214	County: JEFFERSON
Site Contact: MATT JORDAN			Title: CONTACT		Phone #: (812) 342-5700
Inspection Type: Routine		Purpose: Comprehensive			
Inspection Date: 7/19/04		Time: Start 11:45 a.m. End 12:30 p.m.			
Latitude: 38° 8' 49.5"			Longitude: 85° 46' 31.156"		
Coordinate Collection Method: ADD					

I. Administrative Requirements (General Requirements)

Owner Name:	Owner Address:	Total # of tanks:
KP OIL INC	3801 TUPELO DR COLUMBUS IN 47202	5
Operator Name:	Operator Address:	
KIEL BROTHERS OIL CO INC	3801 TUPELO DR, COLUMBUS IN 47202	

☐ Check here if any information does not match notification form. (If checked, request amended notification)

Is current Certificate of Registration posted? Yes If no, are fees current? Yes

#	TANK AND PIPING INFORMATION	Tank# 4	Tank#5	Tank#	Tank#	Tank#
1	Status	TAC	TAC			
2	Month & year installed	05/90	01/90			
3	Capacity (gallons)	12000	12000			
4	Hazardous Substance Tank – confirm secondary cont. / double walled (Yes/No)					
5	Product (specify type)	GAS	CMP			
6	Tank construction material	SST	SST			
7	Tank corrosion protection	CCP	CCP			
8	Number of tank compartments	1	2			
9	Tank manifolded No					
10	Tank presently in use? If no indicate date last used (M/D/Y) and complete section II(i).					
11	Piping construction material	FRP	FRP			
12	Piping corrosion protection	FRP	FRP			
13	Multiple pipe runs per tank(Yes / No)					
14	Date of last lining inspection on file					
15	Date of last tank CP test on file	10/01	10/01			
16	Date of last tank tightness test on file					
17	Date of last piping tightness test on file					
18	Spill prevention equipment	CCB	CCB			
19	Overfill prevention equipment	FLR	FLR			

P. SE 02

FACE OIL, EN. CO.



CorPreTek, Inc.
1004 A Main, Holliston, MA 01923
Tel: 508-548-2300 Fax: 508-548-2303

Lab No: 01-180-46
 Division: LIA
 Date: 2001
 State: Arizona

Book A

JEFFERSON COUNTY, KENTUCKY
DIVISION OF ENVIRONMENTAL HEALTH AND PROTECTION

COMPLAINT NO. 349956 R/A 688

DUPLICATES NOS. _____ R/A _____
_____ R/A _____
_____ R/A _____
_____ R/A _____

PULL DATES:

File		

ASSIGNMENT:

3003	13	

EXCEPTION CODES

S SAMPLES (S#) - ATTENDANCE (S#)
X INSPECTION TO COMPLAINT
Y COMPLAINT TO COMPLAINT
DRS FILE COMPLAINT (RESOLVED)

TYPE OF CODES

01 INSPECTION	05 DOCUMENTED VISIT	09 SURVEY/CLINIC(S#)
02 FOLLOW-UP	06 EMERGENCY RESPONSE	10 EDUCATION
03 COMPLAINT	07 OTHER FIELD ACTIVITY	11 SAMPLES (S#)
04 SURVEY (EVALUATION)	08 OFFICE/PHONE	

ACTION CODES

A NO ACTION INDICATED	U RECALL
B INVALID COMPLAINT	V POSITIVE
C ABATED/CORRECTED	W NEGATIVE
D REFERRAL	X SAMPLE REJECTED
E NOTICE TO CORRECT	Y INSPECTION FAILURE
F NOTICE TO SUSPEND	Z CEASE OPERATION
G PERMIT SUSPENDED	#A NO RESPONSE
H PERMIT RE-INSTATED	#B ADVISED
I PERMIT REVOKED	#C BAITED/TREATED
J NOTICE - APPLY/CEASE	#D HEARING NOTICE
K HEARING HELD	#E PRECOURT INSPECTION
L COURT ACTION BEGUN	#F COURT APPEARANCE
M COURT JUDGMENT	#G SITE EVAL. FAILURE
N INJUNCTION	#H SUSPENSION - FOOD
O VOLUNTARY ACTION	#I SUSPENSION - RETAIL
P OFFICIAL ACTION INDICATED	#J SITE UNAPPROVABLE
	#K AFFIDAVIT
	#L VARIANCE ISSUED

Q QUARANTINE
R RELEASED
S SITE EVALUATION APPROVED
T DYE TESTING

COURT CODES

L COURT ACTION BEGUN
#E PRECOURT INSPECTION
#F COURT APPEARANCE - NO DISPOSITION
CA HOUSING COURT APPEARANCE
CB NOT CORRECTED, FINE ASSESSED
CC CORRECTED W/ A FINE ASSESSED
CD CORRECTED W/O A FINE ASSESSED
CE CORRECTED WITH FINE SUSPENDED
PENDING FUTURE COMPLIANCE
CF NOT GUILTY - CASE DISMISSED
CG CASE REINSTATED, MOTION TO REVOKE FINE
CH BENCH WARRANT ISSUED
CI DISMISSED FOR NON-SERVICE
CJ DISMISSED FOR OTHER REASON

AMP
file

Complaint No:

349956

Address Of Problem Site:

5469 New Cut Rd

CENSUS

TRACT:

KY 40214

UNKNOWN AMOUNT OF DIESEL IN WATER NOTICED BY LOUIS
WATER CO. WORKER WHILE DOING WORK AT ABOVE ADDRESS

PERSON OR PREMISES TO SEE:

LOUIS. FIRE DEPT.

LOUIS. FIRE DEPT.

SANIT	TYPE	COURT	EPI
03003	C	N	N
3005			

COMMENTS

[illegible]

